

## SPECIFICATION

Finish	RAL 9003
Materials	Mild Steel
Weight	0.3Kg. + Fitting
Ingress protection	IP20

Emergency LED Indicator Notch

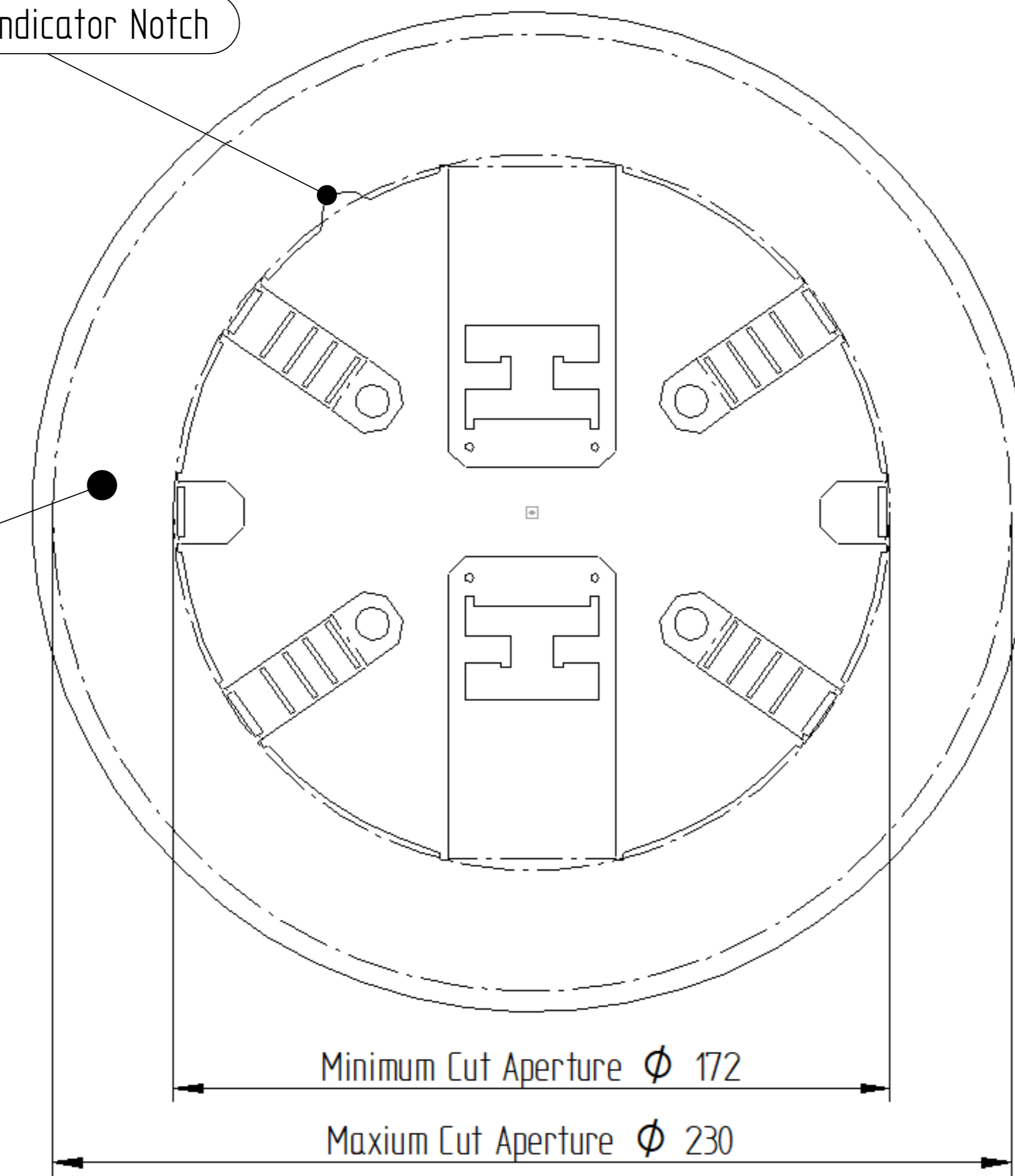

Step 1 - Ensure that the hole trying to cover is within the the Minimum and Maximum Range

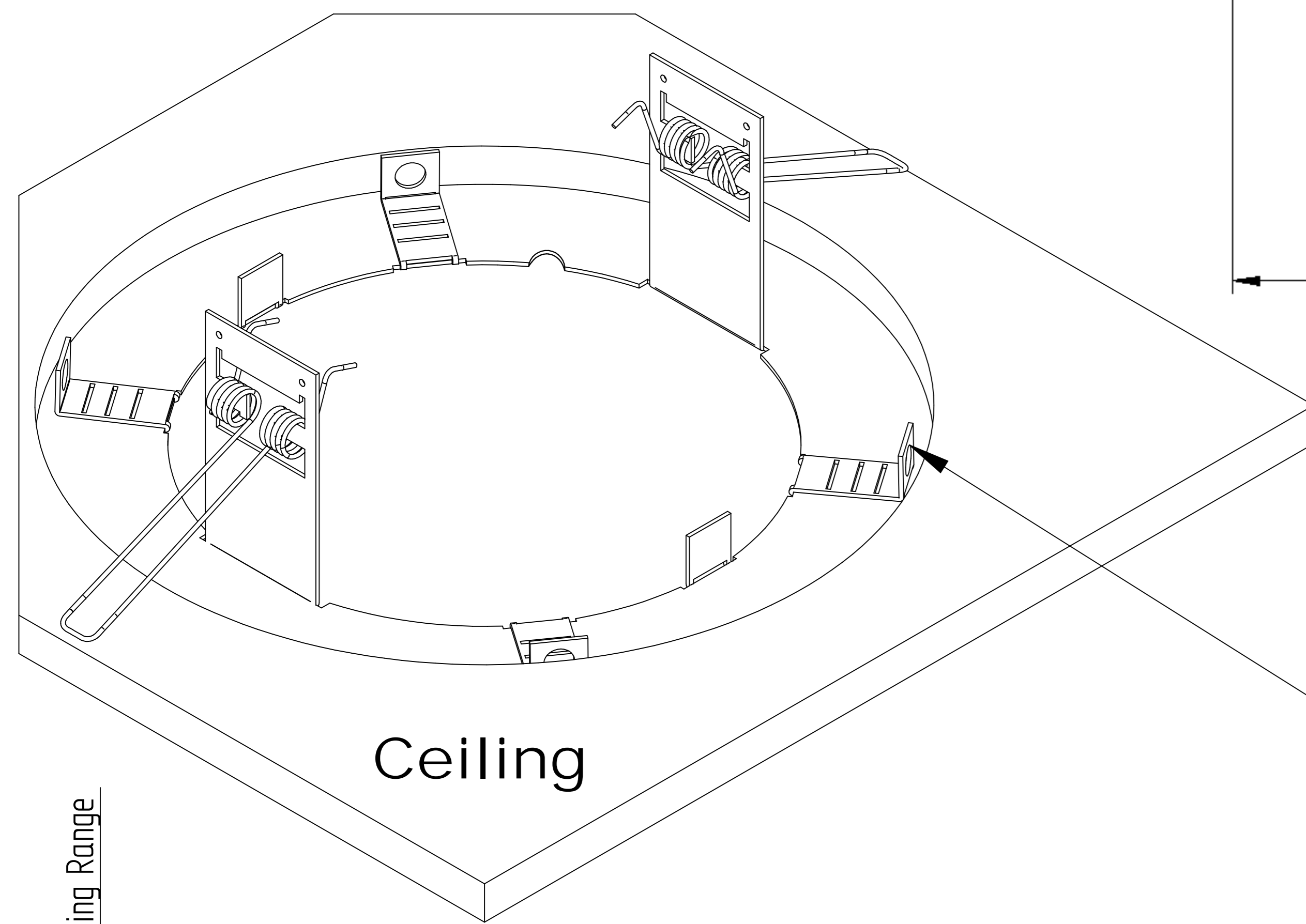

Step 2 - Fold 4 tabs as shown to centre the bezel in the hole there are a number of different easy folds for different diameters select bend closest to your hole size

Step 3 - Fold back the springs on the retro fit bezel and place them through the ceiling void and release so that the bezel is held up against the ceiling

10-40mm  
Bezel Fixing Range

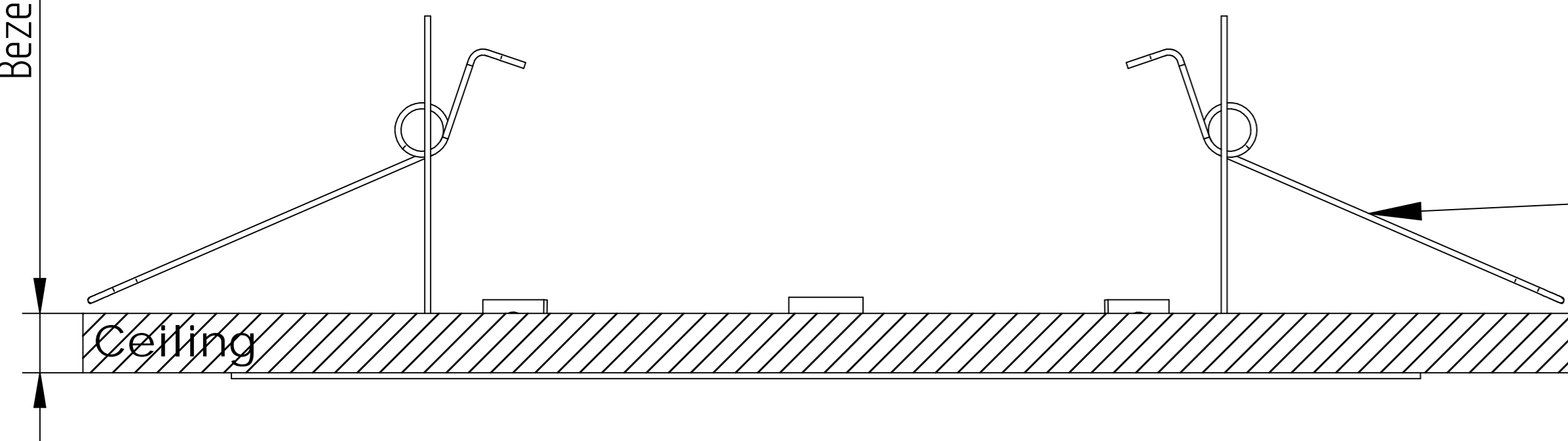

Step 4 - Wire up the driver from the product through the aperture, then install the fitting by bending up the springs and instering them into the void at 90 degrees from the retro fit bezel springs and releasing the product so that it pulls up to the ceiling.

Align Emergency LED Indicator with Notch

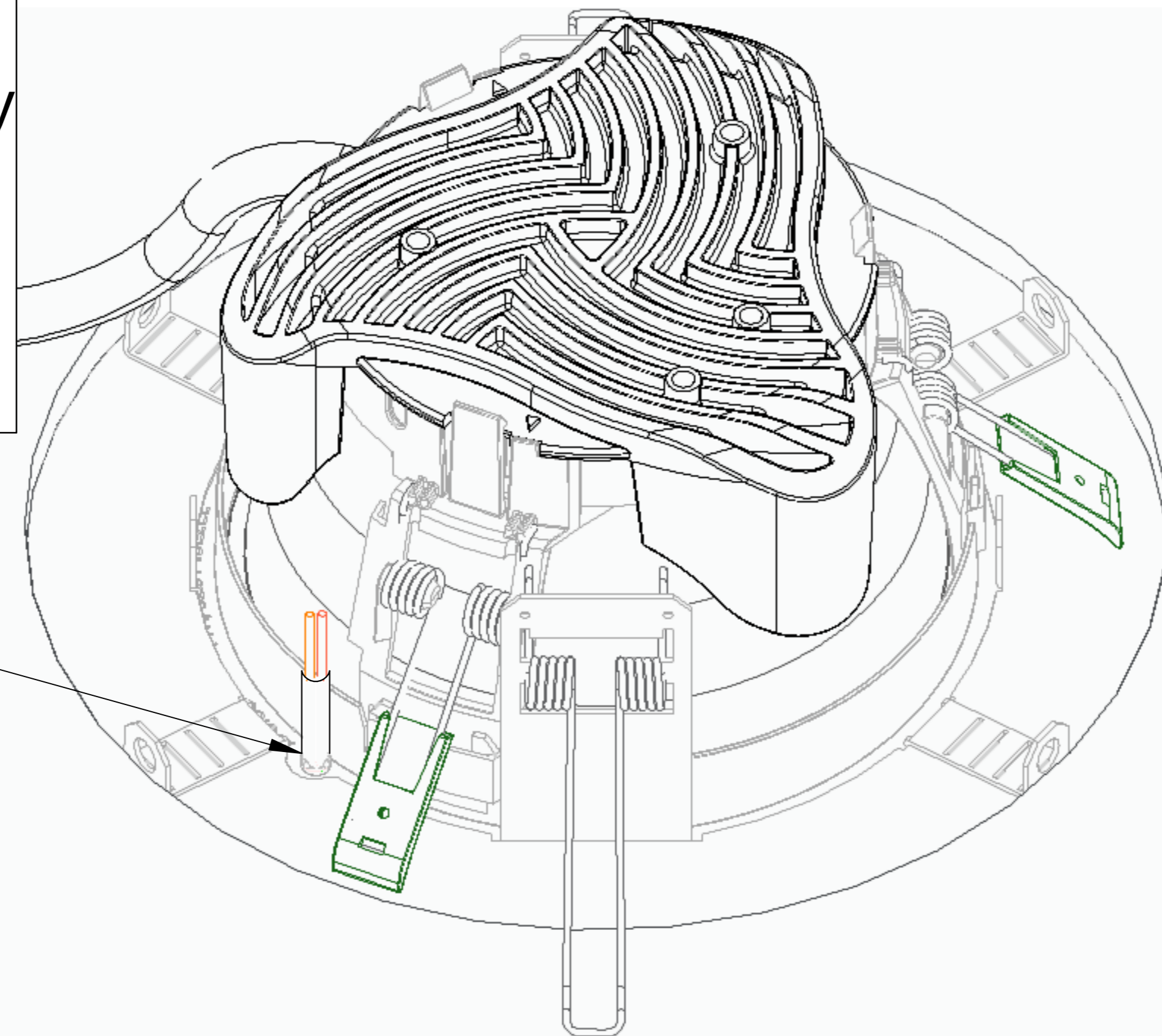

Whitecroft  
lighting

## Esprit Retro Fit

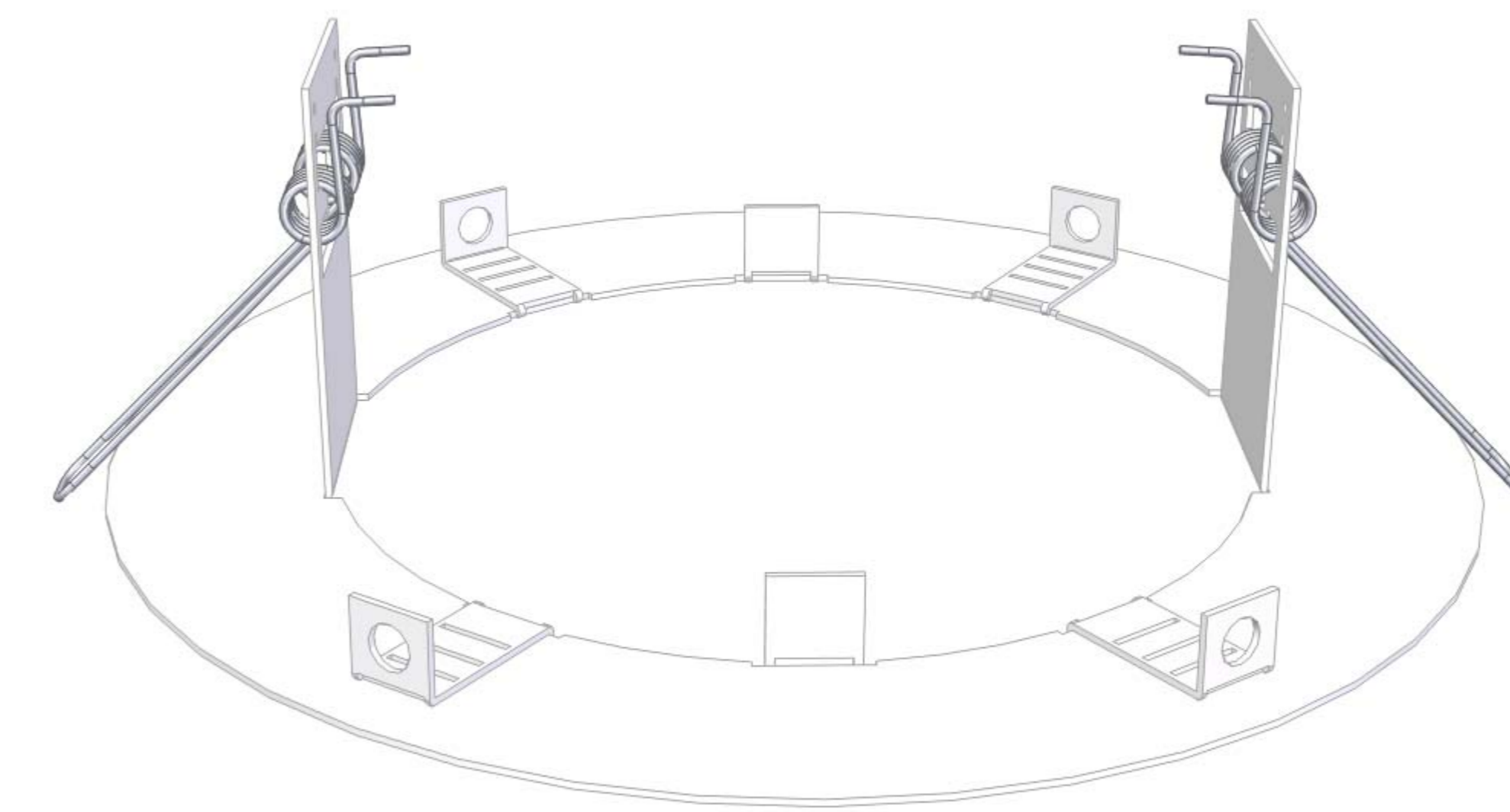

## Installation Instruction

PK/ESPRITRETRO-IL

NOVEMBER 2021 - Rev A

## Whitecroft Lighting Limited

Burlington Street, Ashton-under-Lyne, Lancashire OL7 0AX  
Telephone +44 (0)161 330 6811 Facsimile: +44 (0)161 331 5855  
Registered No. 3848973 England Registered Office: As above

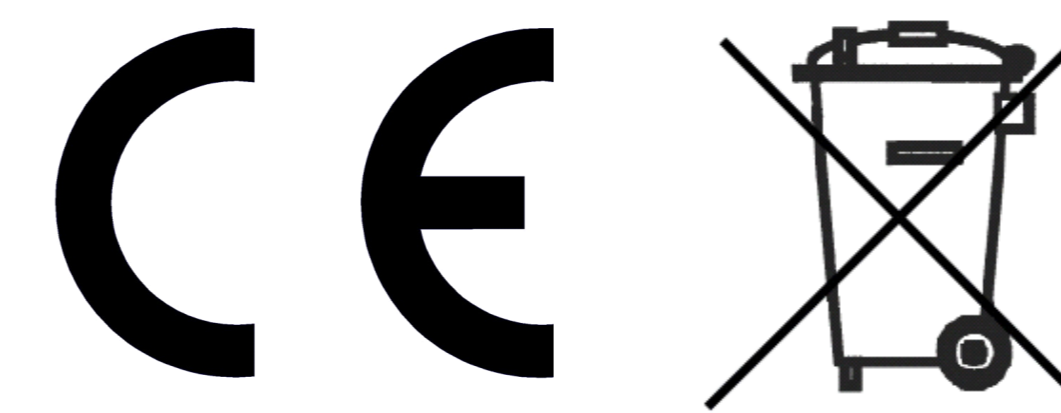

TECHNICAL SUPPORT  
Telephone: 0161 331 5700  
Email: [technical@whitecroftlight.com](mailto:technical@whitecroftlight.com)  
<http://whitecroftlighting.com/>