

SPECIFICATION:

Lamp type:	LED
Output:	5200lm / 6200lm / 8300lm nominal.
Colour:	4000°K - Ra80 (840)
Materials:	
Body:	Perforated steel
Diffusers:	Extruded Polycarbonate
Acoustic:	80Kg/m ³ Rockwool
Body colour:	Silver RAL9006 / White RAL9003
Control gear:	Fixed output / Dali
Emergency:	Integral NM 3hr Florin/ Integral NM COMEPS Florin
Supply:	220-240v 50/60Hz AC
Ambient Temperature:	0-25°C
Supply terminals:	2.5mm ² unfused piano-block
Ingress protection:	IP20



GENERAL INFORMATION

1. A qualified electrician, in accordance with IEE wiring regulations should carry out connection to mains wiring.
2. Observe ESD precautions during installation.
3. This unit must be EARTHED.
4. Ensure that the rated voltage and frequency requirements are compatible with the available mains supply.
5. Cleaning of reflectors and lenses should be carried out using clean, soft and lint free cloths and anti-static cleaning fluid
6. Do not carry out high voltage insulation test, i.e. 500/1000v this may damage internal components.
7. Replacing the light source within this luminaire shall only be carried out by the manufacturer, service agent or a similar qualified person.
8. Ensure mains power is turned off during maintenance.

TECHNICAL SUPPORT
Telephone: 0161 331 5700
E-mail: technical@whitecroftlight.com
<http://www.whitecroftlighting.com/>

Whitecroft
lighting



Installation instructions

Foil XS-Line



PK/FXSINST

Whitecroft Lighting Limited

Burlington Street, Ashton-under-Lyne, Lancashire OL7 0AX
Telephone +44 (0)870 5 087 087 Facsimile: +44 (0)870 5 084 210
Registered No. 3848973 England Registered Office: As above

April 2018, Rev 3

Foil XS-Line

Whitecroft Lighting Limited

FSE####
Luminaire

- denotes part variables
colour, gear etc..

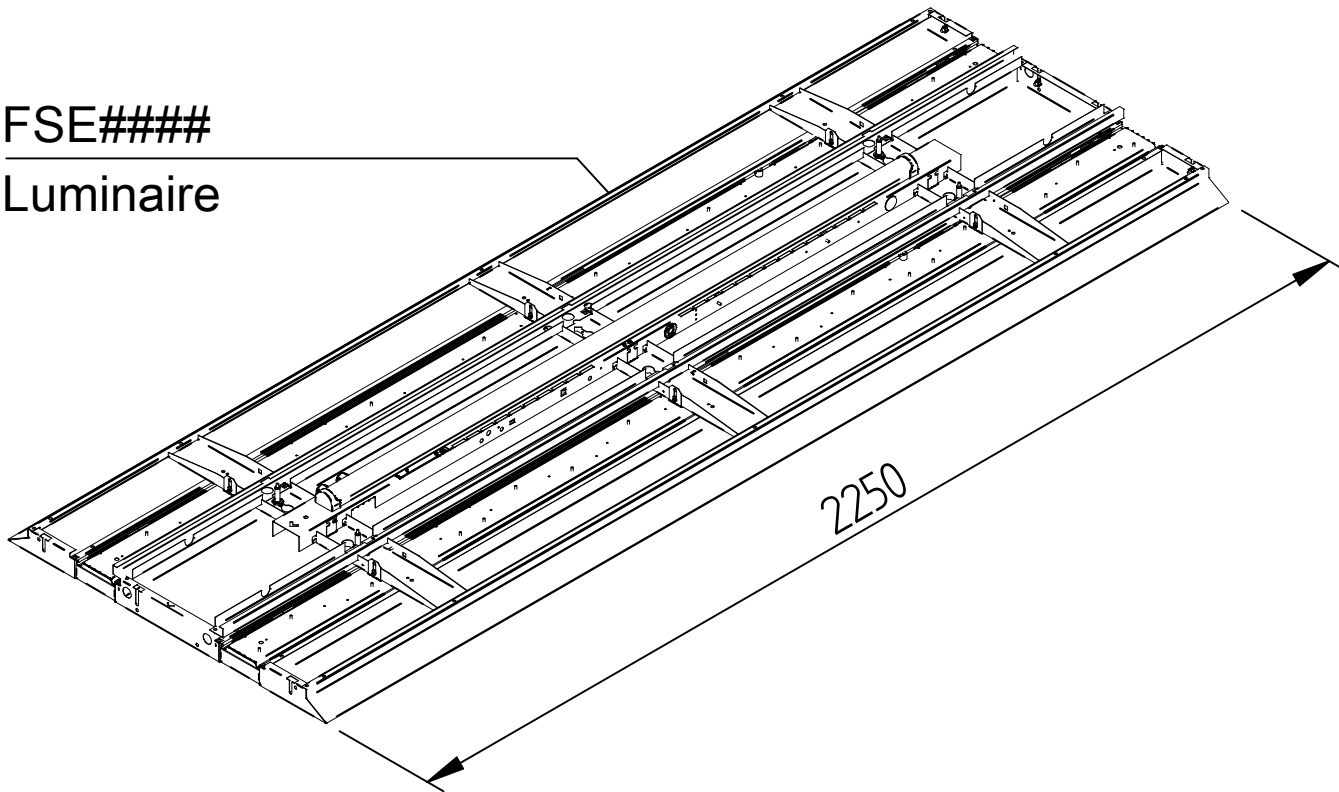

FXINF6#
600mm infill

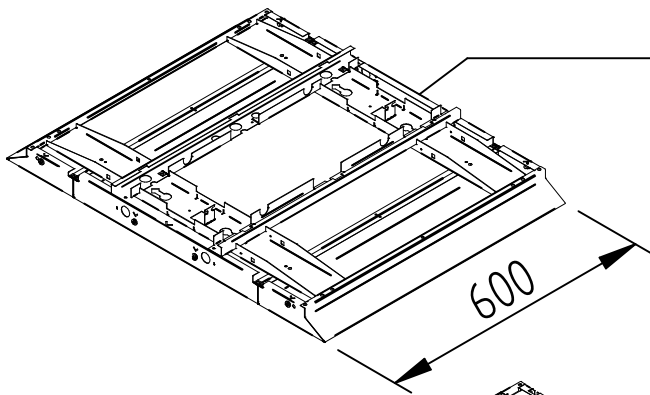

FXINF12#
1200mm infill

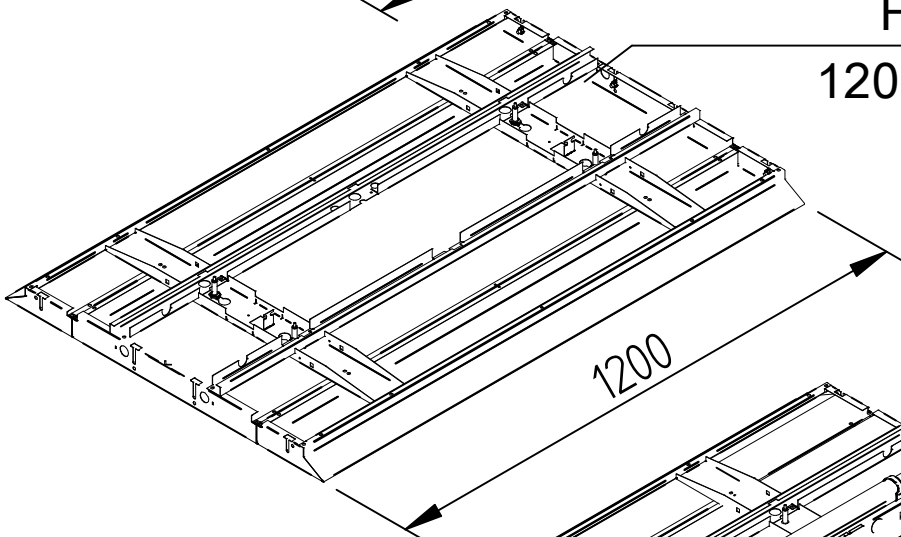

FXENDCFL#
Flat endcap

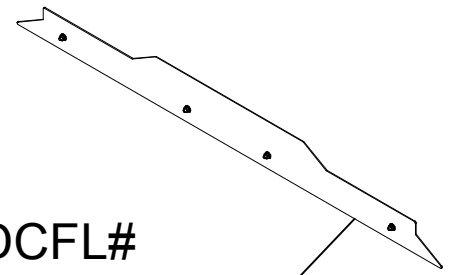

FXINF18##
1800mm infill

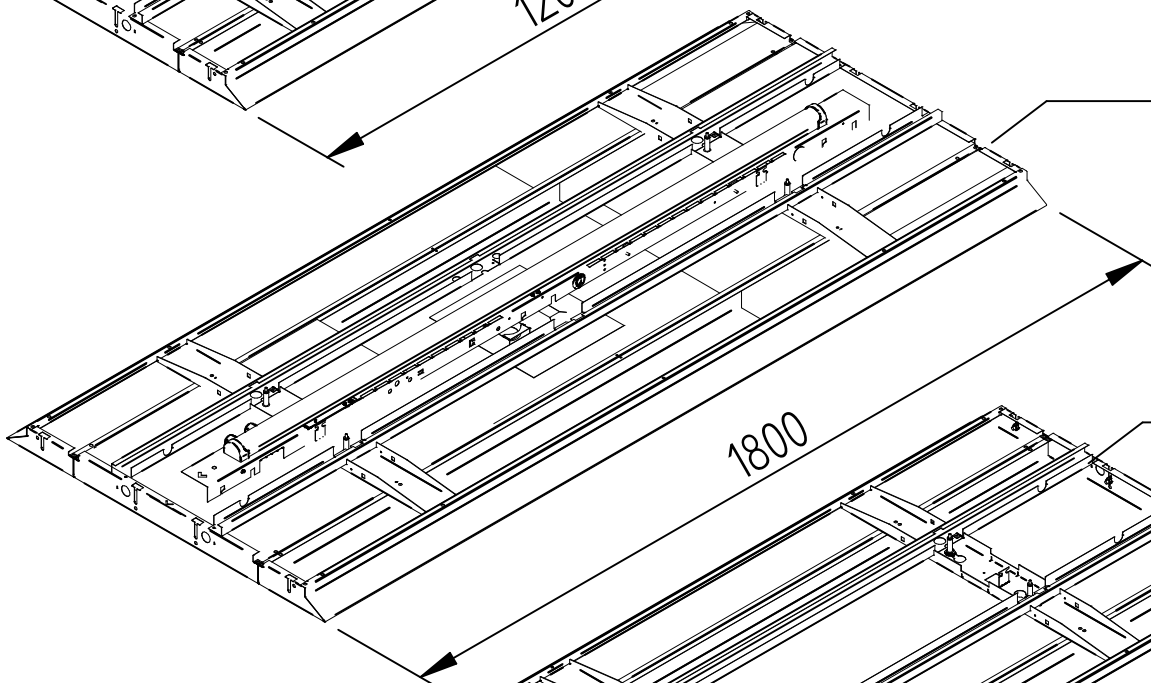

FXINF22##
2250mm infill

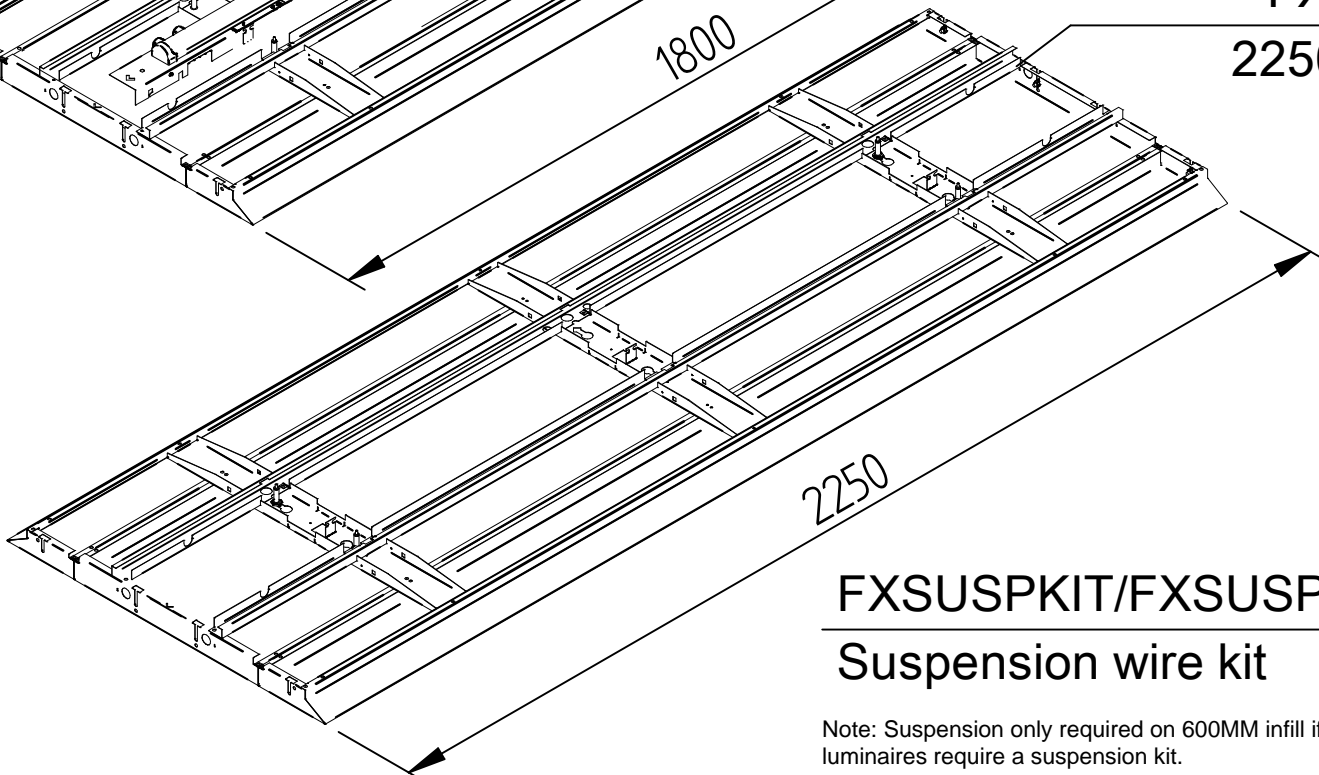

FXSUSPKIT/FXSUSPKIT3M
Suspension wire kit

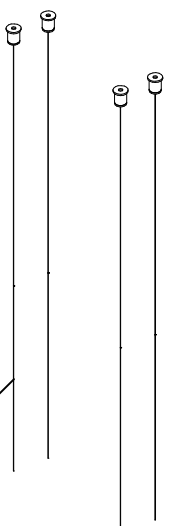

Note: Suspension only required on 600MM infill if mounted at the end of rows. All other size infills and luminaires require a suspension kit.

Foil XS-Line

Whitecroft Lighting Limited

Wire suspension preparation.

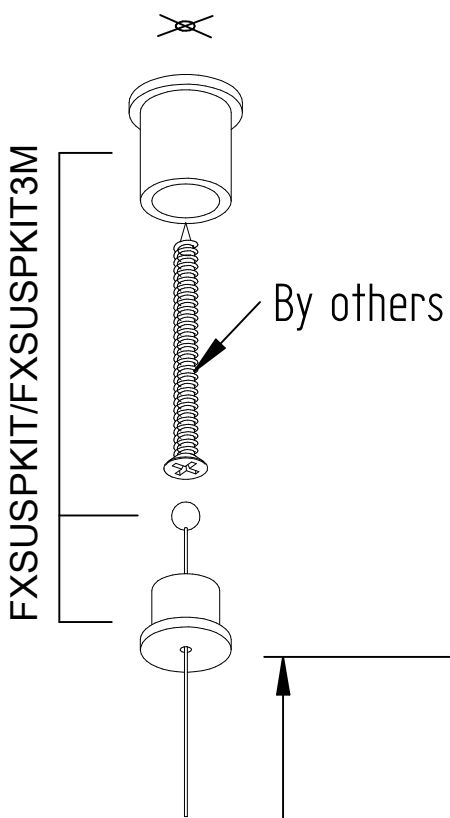

Product parameters				
Part No.	Overall Length (O'A)	Suspension centres SL	Suspension centres SW	Weight (Kg)
2250mm luminaire	2250	1500	200	28-29.5
2250mm infill	2250	1500	200	20-21.5
1800mm infill	1800	1100	200	17-18.5
1200mm infill	1200	750	200	10.5-12
600mm infill	600	450	200	5.5-7
Starter tray	600	n/a	n/a	4

Dimensions: Luminaires and Infills

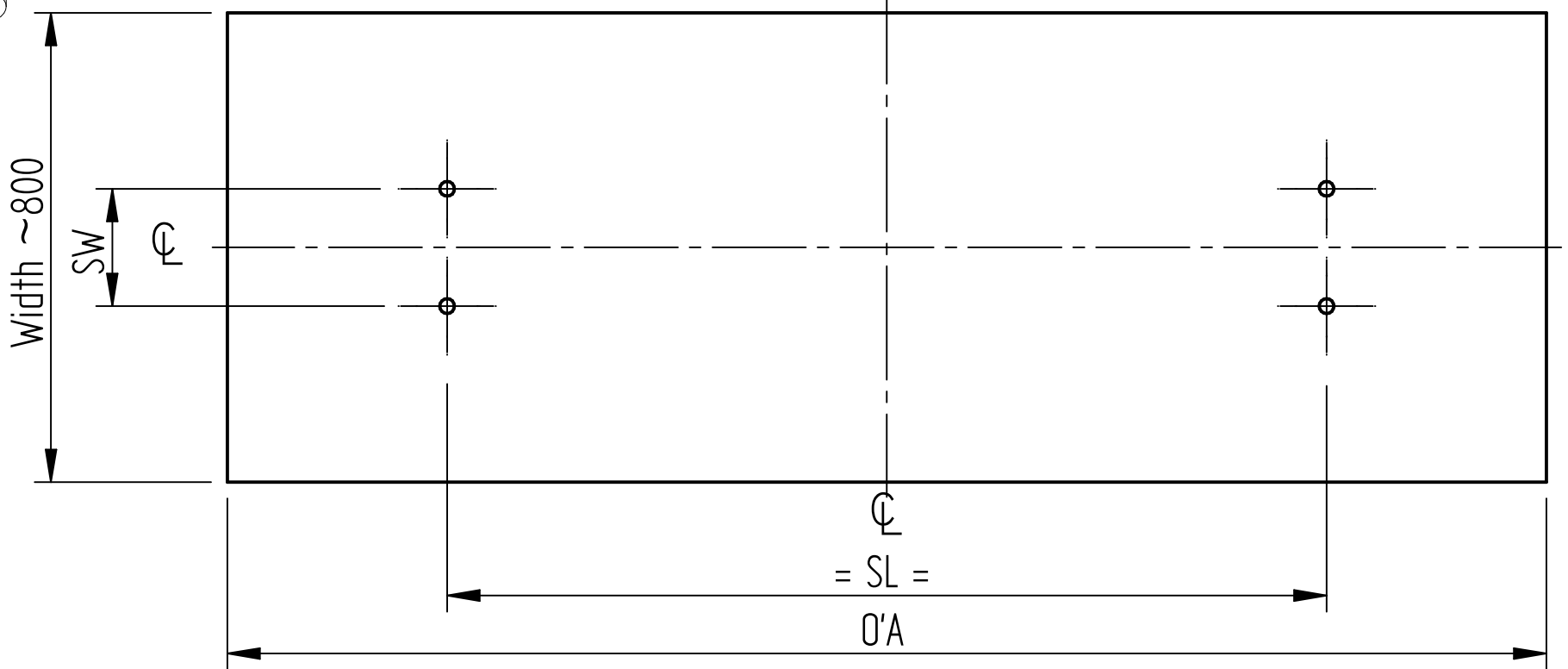

Luminaire orientation.

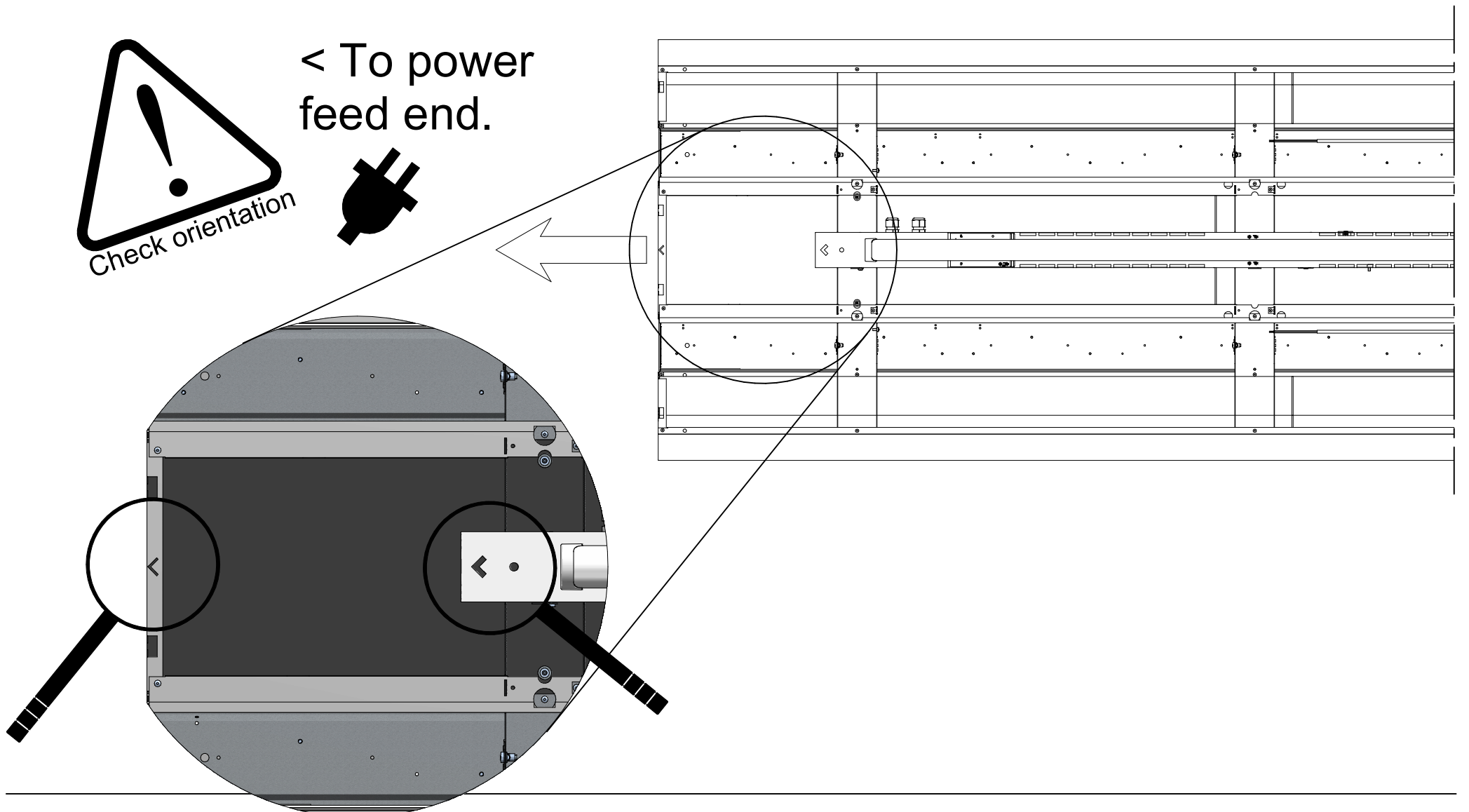

Foil XS-Line

Whitecroft Lighting Limited

Joining bodies together.

- Luminaires
- Infill $\geq 1200\text{mm}$

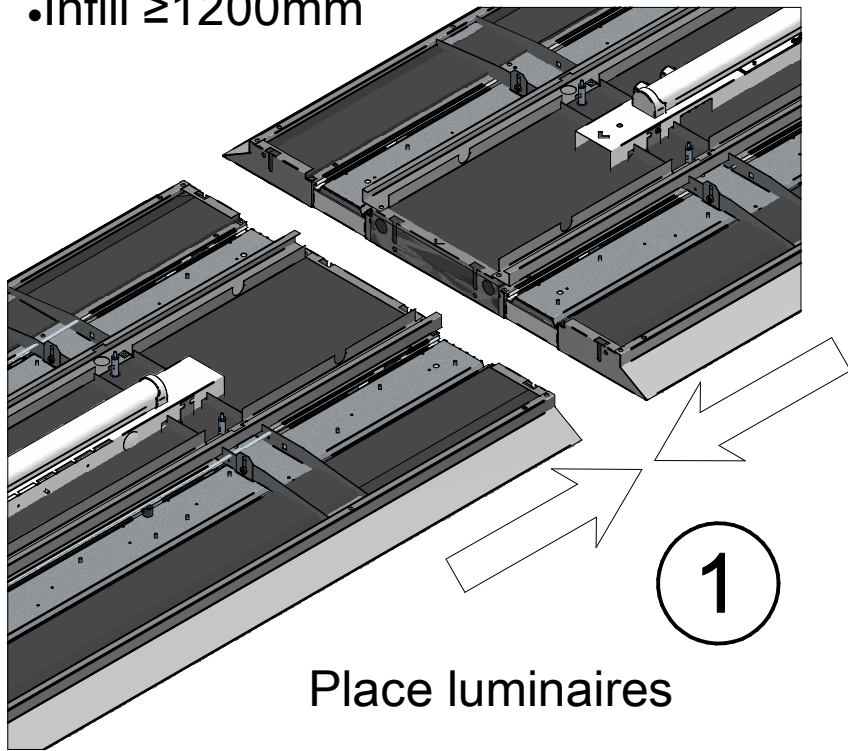

2 4x
Fit fixings

34085/FXJOINTKIT

This diagram shows a close-up of a luminaire body with four circular holes. A blue cylindrical fitting is being inserted into one of the holes. An arrow points from the fitting to the hole.

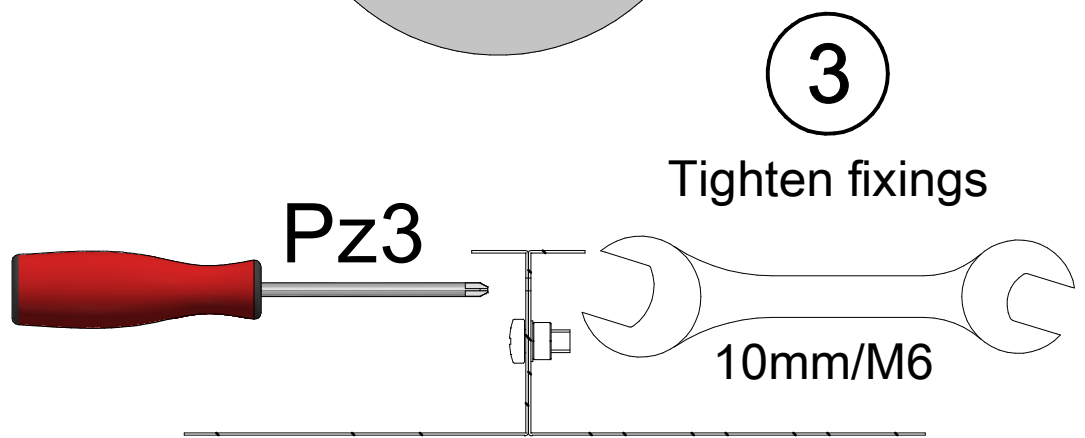

Joining infills $< 1200\text{mm}$.

34085/FXJOINTKIT from FXINF6S###
34085/FXJOINTKIT from adjacent luminaire

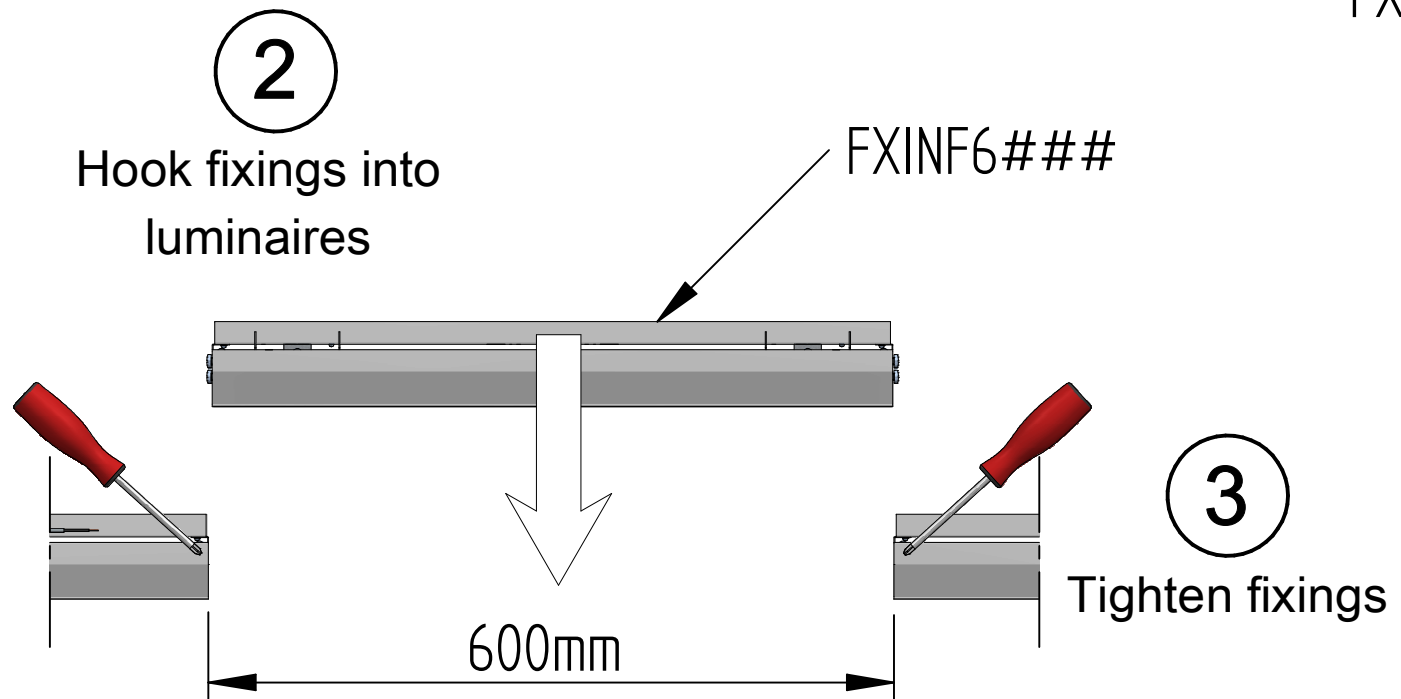
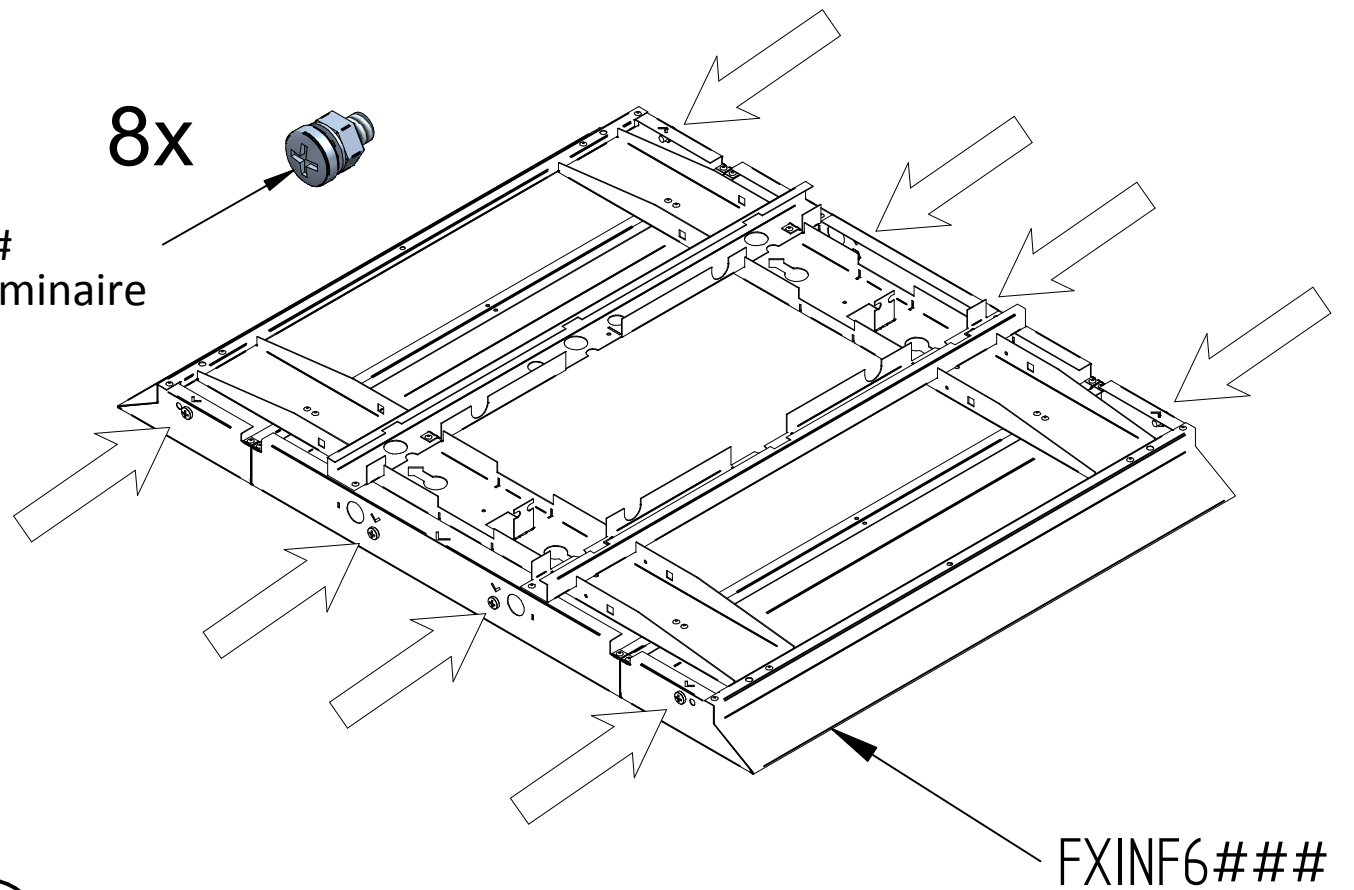
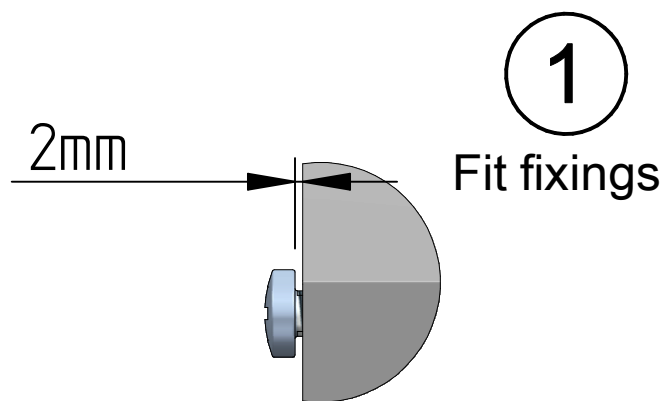

Foil XS-Line

Whitecroft Lighting Limited

Fitting flat endcaps.

FXENDCFL#

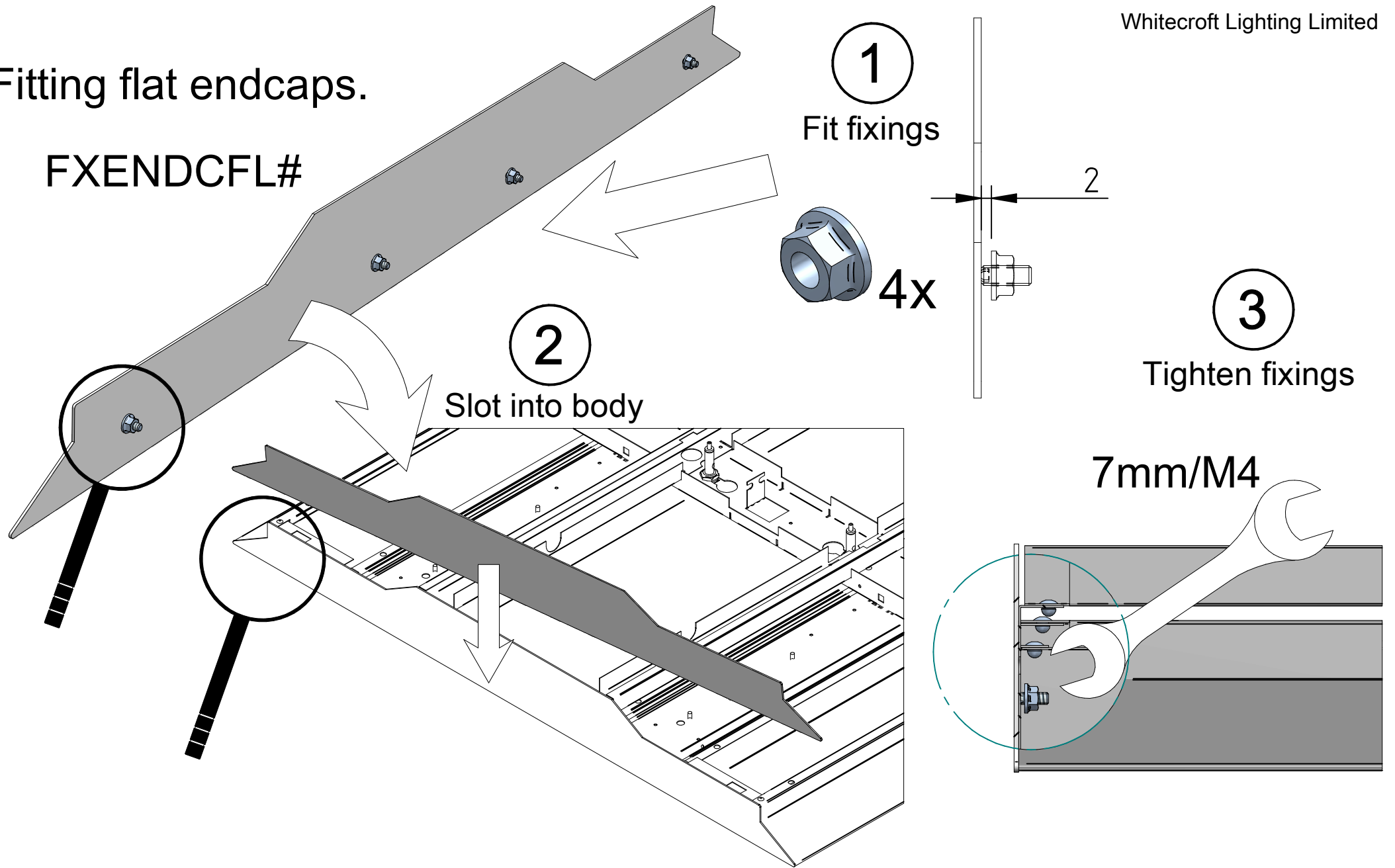

Alternative diffuser position.

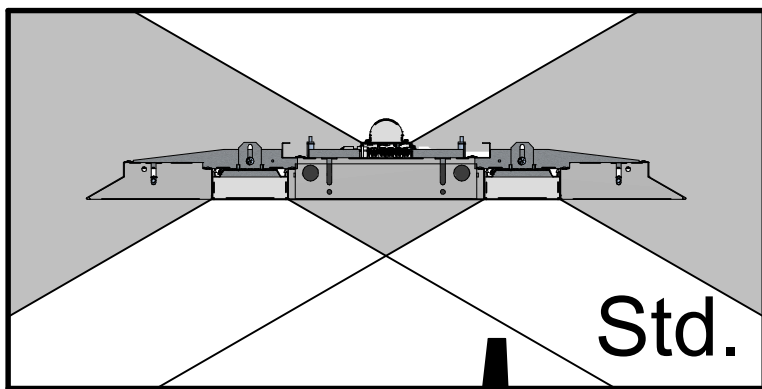

Factory setting

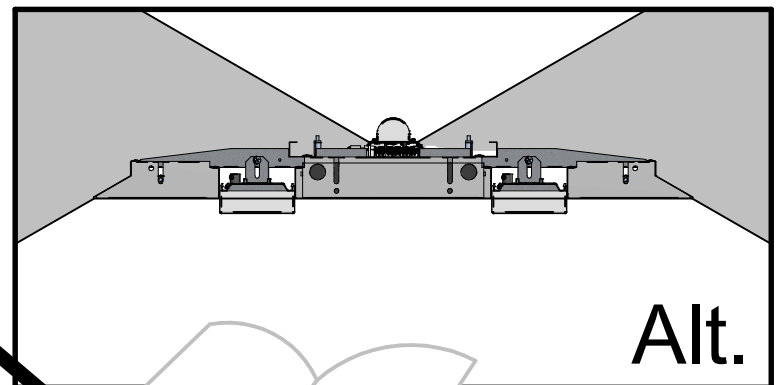

Check Lighting Design

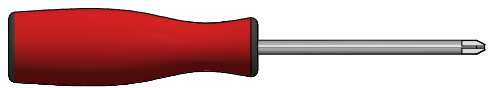

6x

1 Release screws

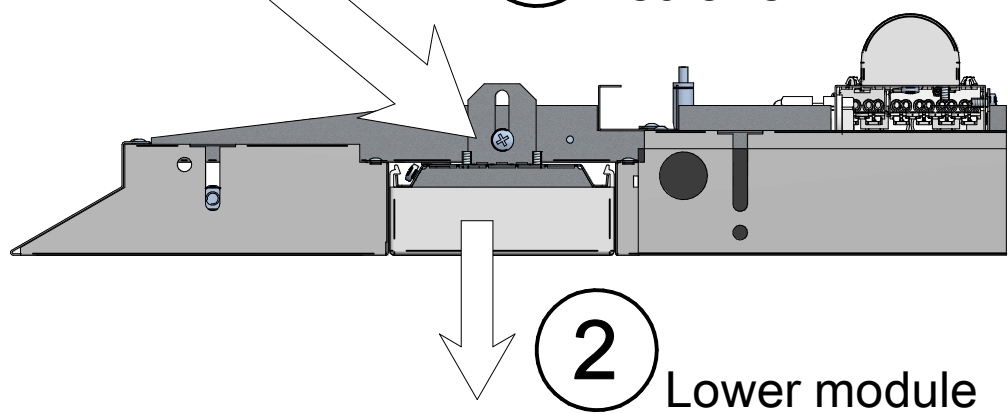

6x

3 Re-tighten screws

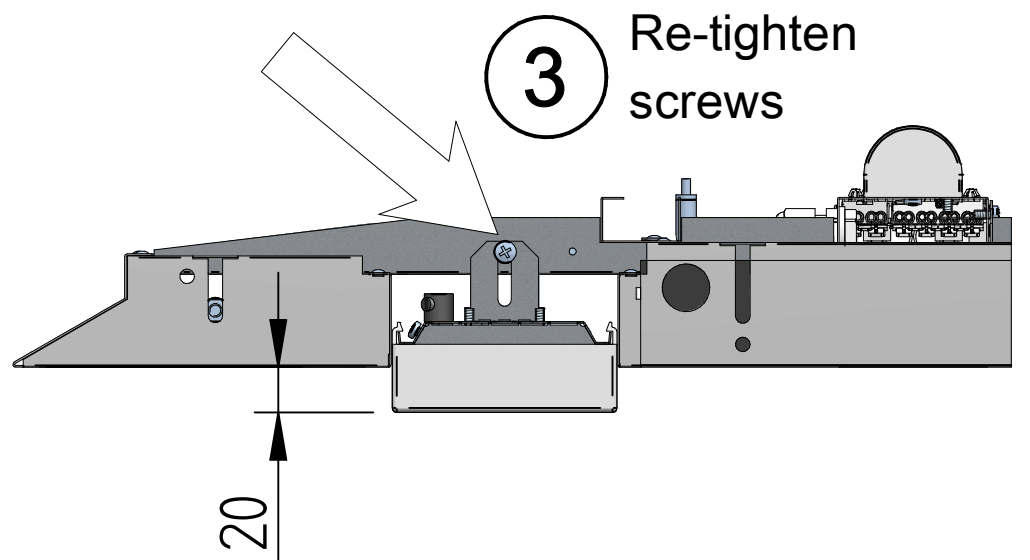

Electrical connections.

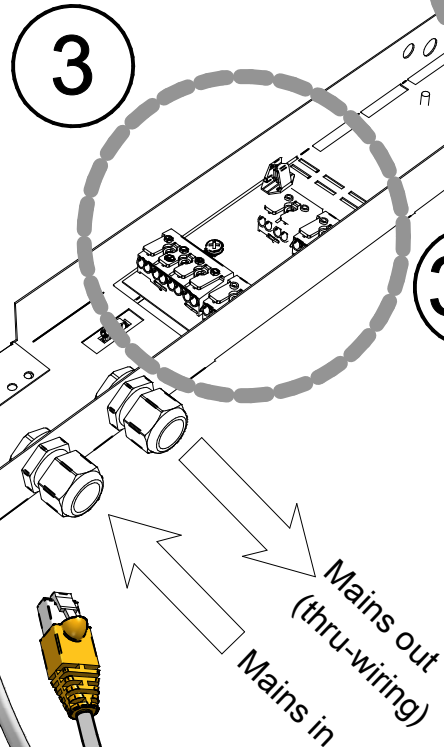
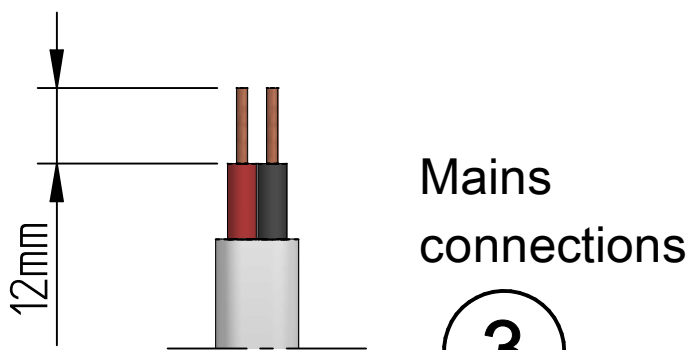
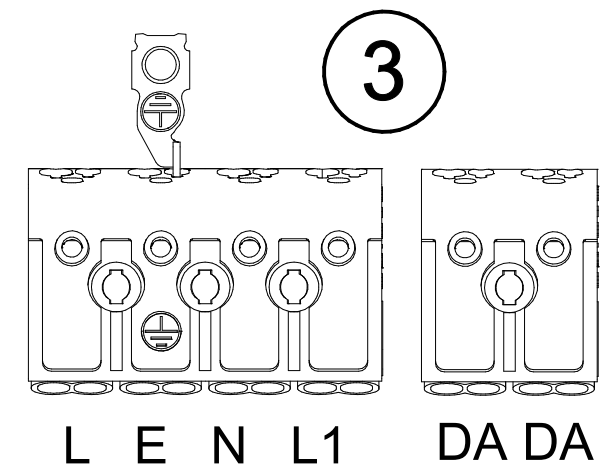
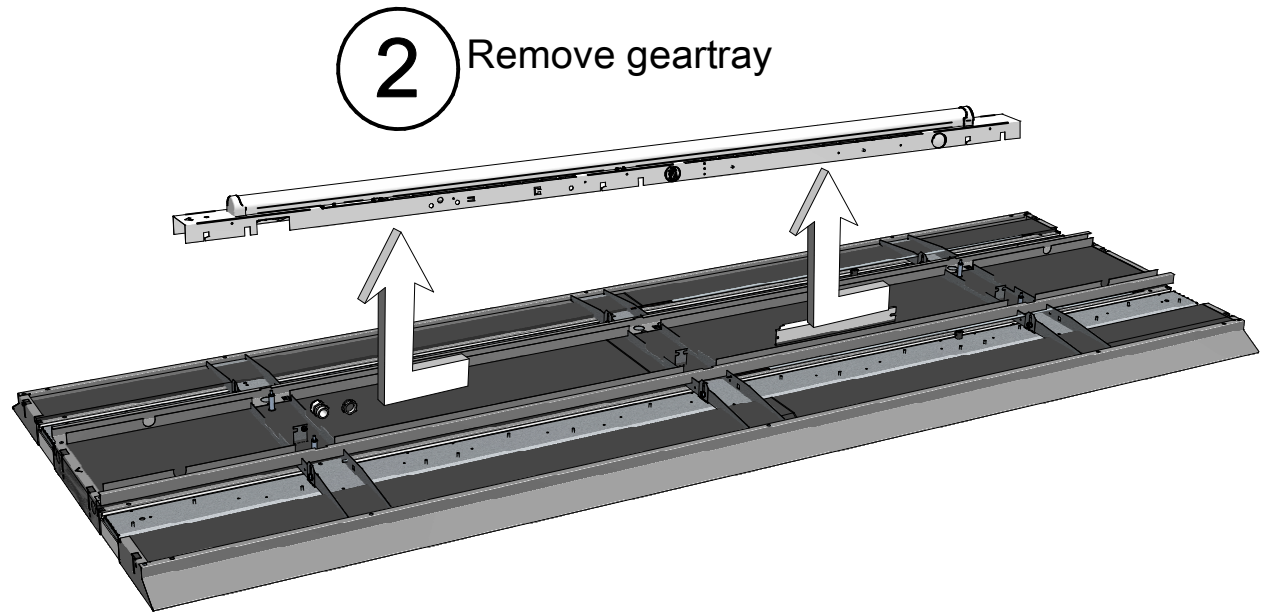
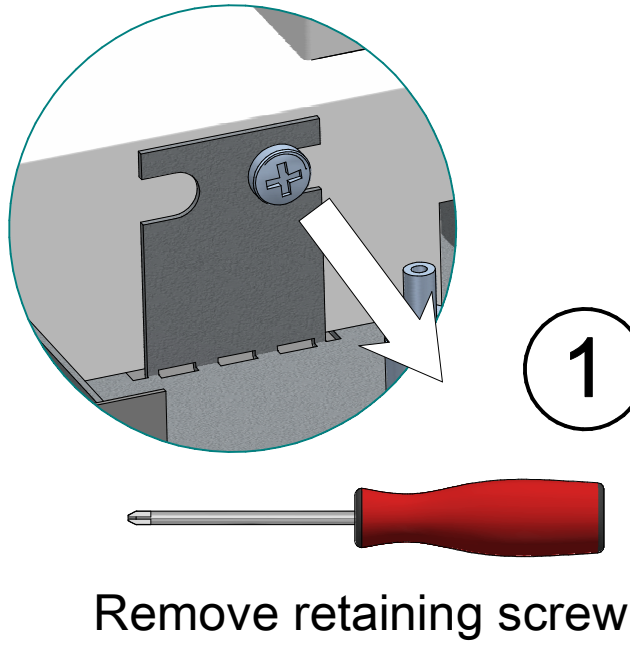

COM4Gamma (optional)

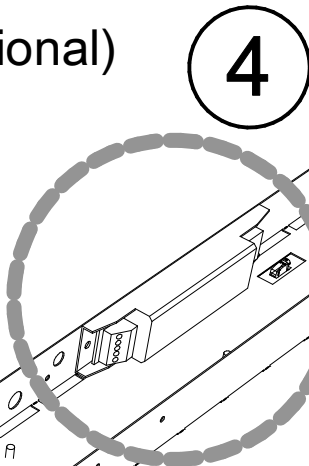

Emergency (optional): Connect battery

