

GENERAL INFORMATION

- 1) A qualified electrician, in accordance with IEE wiring regulations, should carry out connection to mains wiring.
- 2) Ensure that the rated voltage and frequency requirements are compatible with the available mains supply.
- 3) Cleaning of reflectors and lenses should be carried out using clean, soft and lint free cloths and anti-static cleaning fluid.
- 4) Do not carry out high voltage insulation test, i.e. 500/1000v as this may damage internal components.
- 5) We recommend use of a high temperature Copper Paste on all screws that need to be accessed during maintenance process, this will prolong the life of the fixings and reduce the force required to remove the screws.
- 6) Some luminaires installed in outdoor environments may experience a build-up of internal condensation. This is due to a difference in temperature between inside and outside the luminaire which is quite common and acceptable under BSEN60598.

GENERAL MAINTENANCE

To access the inside of the luminaire, remove all 4 screws around the top of the luminaire, with a size 4 Allen Key. Lift the lid off the top of the luminaire. After this the general maintenance can be performed. Then reverse the process to replace cover.

Please note: All images shown are for illustration purposes and should be used as a reference guide only.

TECHNICAL SUPPORT

Tel: 0161 331 5700

E-mail: technical@whitecroflighting.com
www.whitecroflighting.com



Broadwalk L180 Installation Leaflet

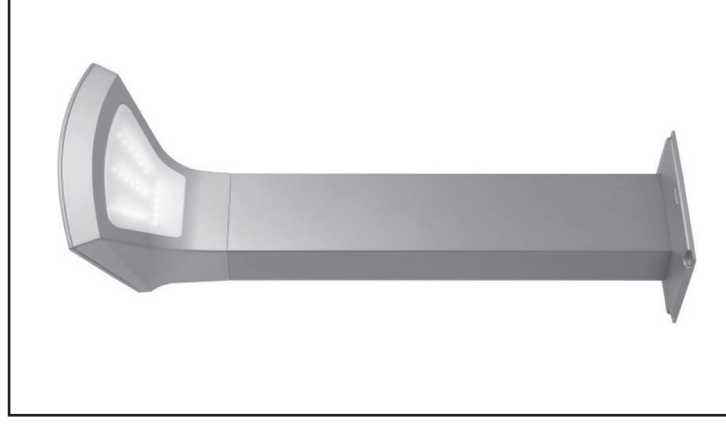

PK/LEAF/BROAD180



September 2017 - Rev C

Whitecroft Lighting Limited

Burlington Street, Ashton-under-Lyne, Lancashire OL7 0AX
Telephone: +44 (0)161 330 6811 Facsimile: +44 (0)161 331 5855

www.whitecroflighting.com

Registered No. 3848973 England

Registered Office: As above

SPECIFICATION

The Broadwalk L180 is a floor mounted bollard luminaire. The luminaire must be mounted on a concrete base 400mm x 400mm x 400mm with a 230v supply cable to centre of base.

Each Broadwalk L180 is shipped in one package. Before commencing installation, check contents of the carton to ensure that all components are present and in good condition.

- 1) Main body.
- 2) IP66 Connection block (contractor half)
- 3) 4 x Anchor bolts

INSTALLATION SEQUENCE

In order to fit this luminaire, the correct sequence of assembly must be observed. During installation make sure the power is completely isolated at the mains.

- 1. Remove the luminaire from its packaging along with the IP66 connection bolt and anchor bolts.
- 2. Take the IP66 connection block and wire the cable into the screw terminals. (diameter = 9 to 12mm, 1.5mm² 3 Core rubber insulated) (Fig 1).
- 3. Tighten the IP66 seal round the cable and push the connector into the connection housing until it clicks. (Fig 2).
- 4. Place the luminaire on the top of the concrete base and drill 4 holes so they match with the screw holes on the base of the luminaire.
- 5. Connect the cable to the bottom of the luminaire and twist the housing until it clicks into place. (Fig 3).
- 6. Take your anchor screws and place down the holes, aligning them exactly. (Fig 4).
- 7. Tighten them until the luminaire is totally secure and cannot be moved. (Fig 4).

Height of luminaire	Width Bottom	Length Bottom	Weight
600mm	220mm	300mm	6.2kg
1100mm	220mm	300mm	8.2kg
2400mm	220mm	300mm	13kg

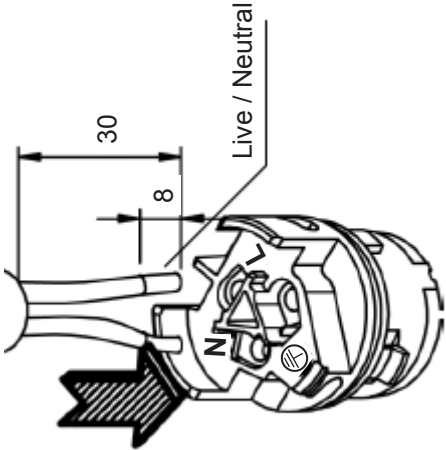
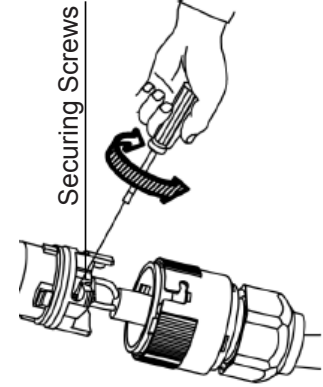

Fig 1

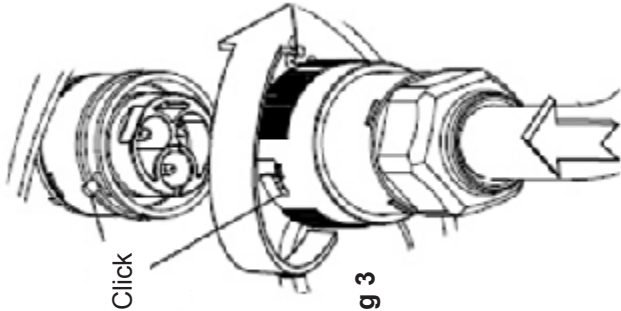

Fig 3

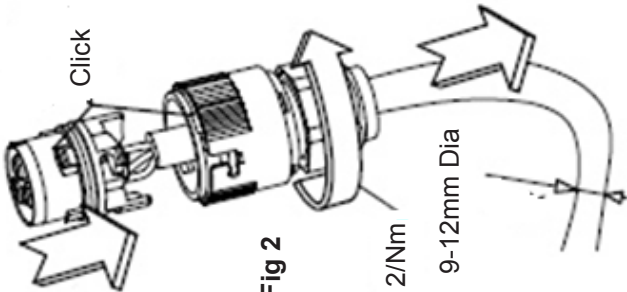

Fig 2

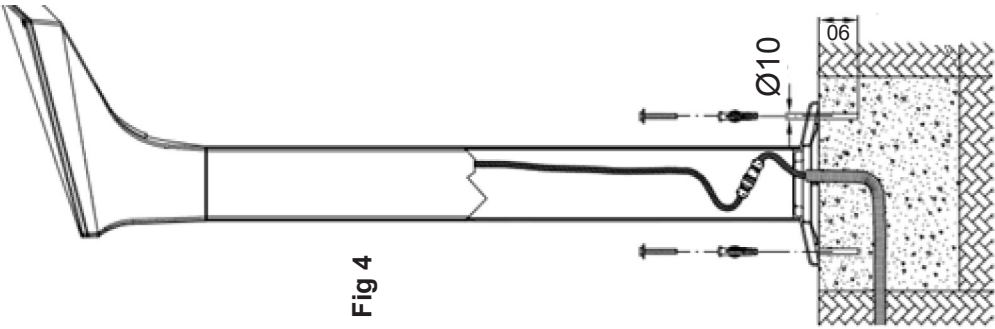
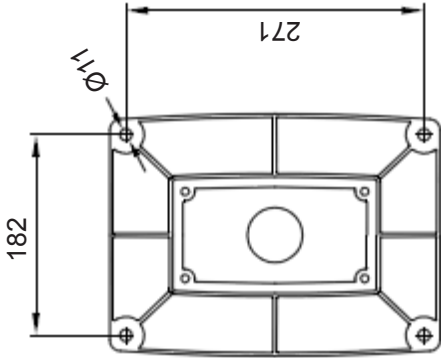

Fig 4