

## GENERAL INFORMATION

- 1) A qualified electrician, in accordance with **IEE** wiring regulations, should carry out connection to mains wiring.
- 2) This unit must be **EARTHED**.
- 3) Ensure that the rated voltage and frequency requirements are compatible with the available mains supply.
- 4) Cleaning of reflectors and lenses should be carried out using clean, soft and lint free cloths and anti-static cleaning fluid
- 5) Do not carry out high voltage insulation test, i.e. 500/1000v this may damage internal components.
- 4) Do not touch the reflectors or the diffuser during installation. Please handle the luminaire from the plastic end-caps only.

The following diagram demonstrates how the main input terminals are to be wired:

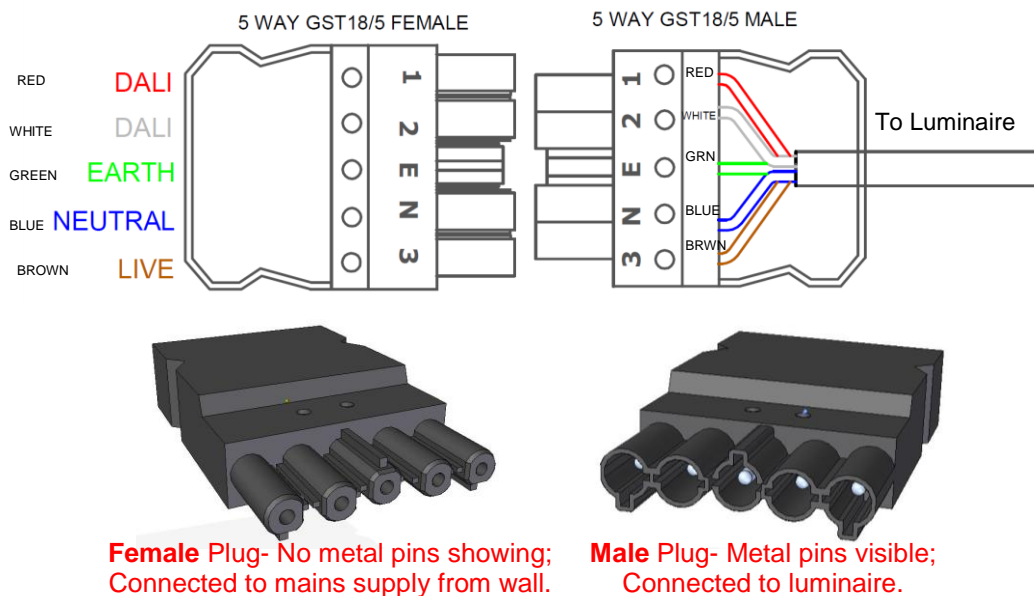

### Please note:

This luminaire requires suitable DALI controls and commissioning to operate within intended design parameters.



## Florence Elite LED



### Installation: *Florence Elite LED*

September 2012 – Rev A



PK/LEAFLET/LED



## Whitecroft Lighting Limited

Burlington Street, Ashton-under-Lyne, Lancashire OL7 0AX  
Telephone +44 (0)870 5 087 087 Facsimile: +44 (0)870 5 084 210

Registered No. 3848973 England

Registered Office: As above

## SPECIFICATION

<b>Lamp type</b>	Uplight - LED (3100lm) Downlight- LED (1500lm)
<b>Finish</b>	White - RAL9003, 30% gloss
<b>Materials</b>	- Polycarbonate diffuser and endcaps - Aluminium body/ Wall plate - Mild Steel brackets
<b>Weight</b>	6kg
<b>Supply</b>	240V AC, 50Hz
<b>Power (Including Ballast)</b>	Uplight- 34W Downlight- 25W
<b>Operating temp</b>	25°C
<b>Connection</b>	5 pole GST plug
<b>Ingress protection</b>	IP40

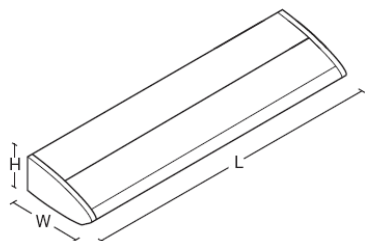
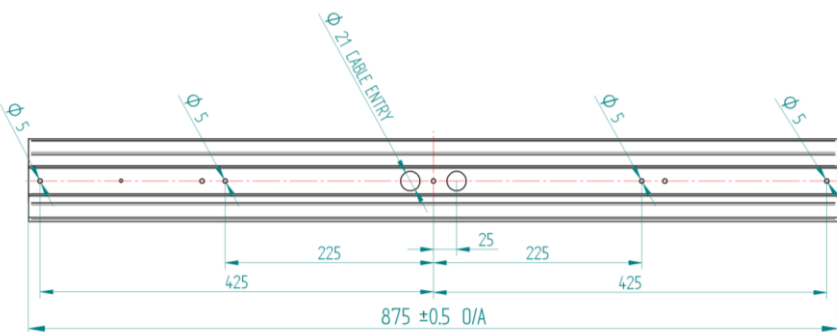

L	W	H	KG
895	213	95	6.0

## INSTALLATION DETAILS

The following parts are supplied in the box:

- 1 1x Wall Fixing Plate
- 2 1x Luminaire Body
- 3 2x Outer End-caps
- 4 2x WALL FIX Screws
- 5 1x Female 5 Pin Plug

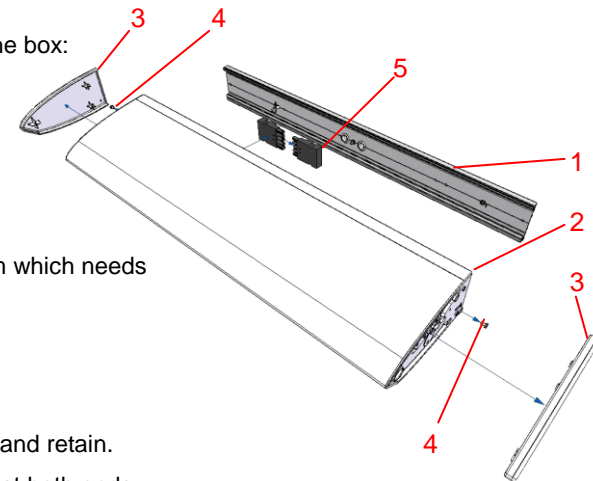

The product is packaged as one item which needs disassembling before installation.

### Installation

- 1) Remove the two outer end-caps and retain.
- 2) Unscrew the 'WALL FIX' screws at both ends.
- 3) Remove the wall plate from the luminaire.
- 4) Raise the Wall Plate up to the wall, ensuring the orientation is correct (unpainted section up).  
*If the wall is uneven, use spacers behind the plate.*  
Feed the mains and DALI cables through the central apertures on the wall plate.  
Fix to the wall with four screws, using the fixing centres.
- 5) Remove the **Female** plug from the luminaire. Using the **wiring diagram** on the back page of this leaflet, connect the Female plug to the cables protruding through the wall plate.
- 6) Raise the luminaire body up to the wall plate (Note the orientation against the wall). Connect the chain from the wall plate to the body, by feeding the T-piece through the central hole in the body. Connect the loose earth lead to the wall plate.
- 7) Connect the plugs and fix the leads and plugs on the luminaire to the wall plate with the attached cable ties (Note, the tie mounts are releasable).
- 8) Raise the luminaire body, horizontally flush with the wall. Lower the luminaire **vertically** onto wall plate and locate. Do not lever the luminaire into position.
- 9) Fix the luminaire body to the wall plate with the 'WALL FIX' screw at each end.
- 10) Slot on the outer end-caps.

