

GENERAL INFORMATION

- 1) A qualified electrician, in accordance with IEE wiring regulations should carry out connection to mains wiring. Do not attempt to fit the luminaire whilst the mains supply is live.
- 2) Ensure that the rated voltage and frequency requirements are compatible with the available mains supply.
- 3) Do not carry out high voltage insulation test, i.e. 500/1000v this may damage internal components.
- 4) Some luminaires installed in outdoor environments may experience a build-up of internal condensation. This is due to a difference in temperature between inside and outside the luminaire which is quite common and acceptable under BSEN60598.

SPECIFICATION

Lamp types	LED with wide, asymmetric or symmetric optics in 4000K
Materials	Die cast aluminium body in graphite grey or silver finish 4mm thick glass luminaire cover
Supply	220V-240V
Power	25W to 94W dependant on Lumen output
Operating temp	-20°C to +40°C
Ingress protection	IP66 □ Class 2 product
IK Rating	IK08
Weight	4.0KG Small Housing 5.5KG Medium Housing
Mains Frequency	50/60Hz

DIMENSIONS

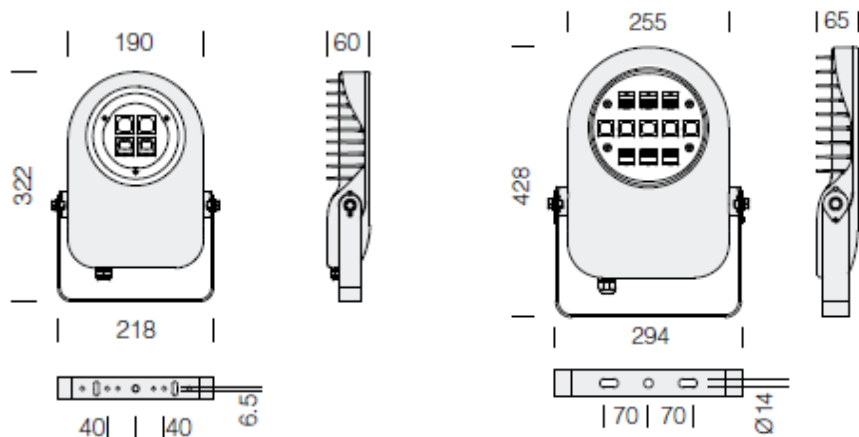

SMALL HOUSING

MEDIUM HOUSING



SELISE

SMALL AND MEDIUM LED FLOODLIGHTS



INSTALLATION INSTRUCTIONS

PK/LEAF/SELISE

May 2014 – Rev A



Whitecroft Lighting Limited

Burlington Street, Ashton-under-Lyne, Lancashire OL7 0AX
Telephone +44 (0)870 5 087 087 Facsimile: +44 (0)870 5 084 210

Registered No. 3848973 England

Registered Office: As above

INSTALLATION

Please note that this leaflet shows the installation process for both the small and medium housing products. Any differentiation in the process will be highlighted.

Fig1

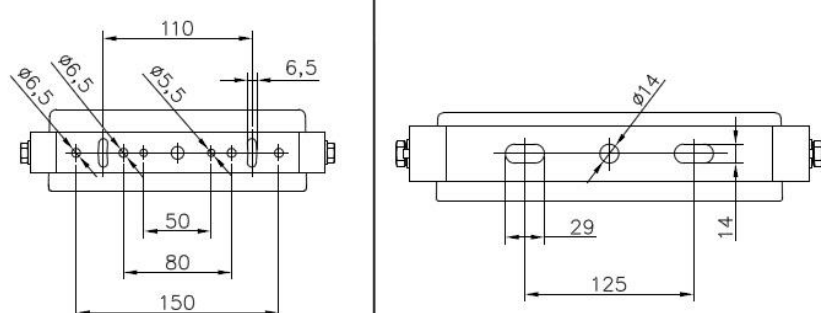

SMALL HOUSING

MEDIUM HOUSING

1. Mount the unit to the wall using the diagram fig.1. Ensure that a suitable air gap between the highest point of the luminaire and any features above is maintained. See fig. 2. Use suitable mounting hardware.

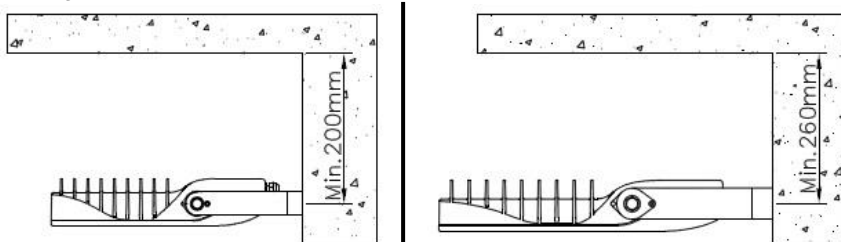

SMALL HOUSING

MEDIUM HOUSING

2. To set the angle of the luminaire loosen the grub screw and then use a spanner to loosen the nut. The luminaire will then freely pivot on the bracket. Once you have set the luminaire to the desired angle tighten the nut with a spanner then tighten the grub screw to the torque ratings as shown in fig.3. You may wish to set the angle before or after wiring the luminaire in place. Note that you should not angle the luminaire greater than 100° off horizontal (fig.4).

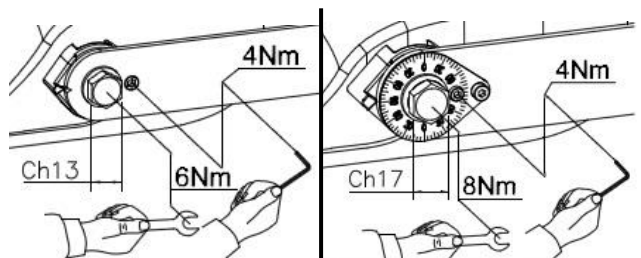

SMALL HOUSING

MEDIUM HOUSING

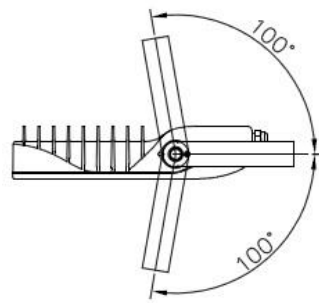

Fig4

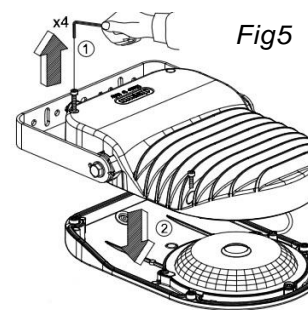
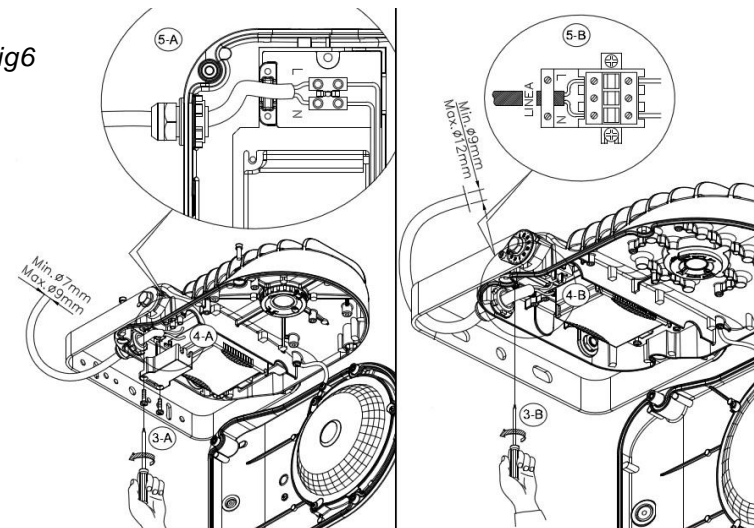

Fig5

3. To access the luminaire internals remove the 4 hex bolts from the upper section. The lower section will come loose. Ensure you have hold of the lower section as the two halves become disconnected as fig 5. Remove the internal terminal block cover if required.

Fig6



SMALL HOUSING

MEDIUM HOUSING

4. Wire the mains to the luminaire as per the images in fig.6. Feed through the mains cable via the IP gland ensuring correct installation as to not compromise the integrity of the product. Use a cable suitable for exterior use. The gland will accept wire with a diameter between 9 and 12mm. This product is not suitable for through wiring.

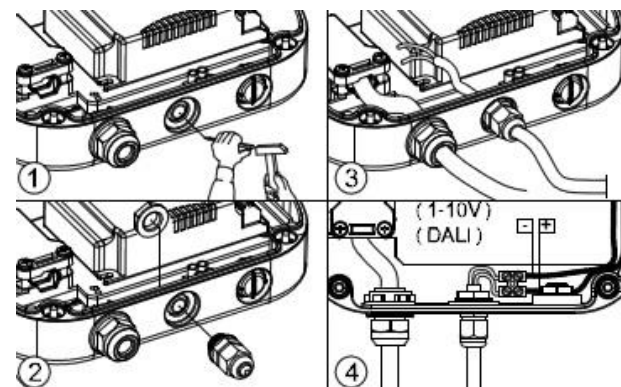

5. To connect a DALI pair to the internal LED driver you will need to first break an extra hole into the luminaire housing before using a suitable IP gland and wire to the terminal blocks as specified in image 4.

6. Carefully reattach the terminal block cover and lower section (tighten screws evenly) and reinstate the mains supply.

TECHNICAL SUPPORT
Telephone: 0161 331 5700

E-mail: technical@whitecroftlighting.com
<http://www.whitecroftlighting.com/>