

General Maintenance

The luminaire can be opened via 4 off hex-socket screws from above. Ensure that the support/stay is engaged when working on this luminaire to prevent injury.

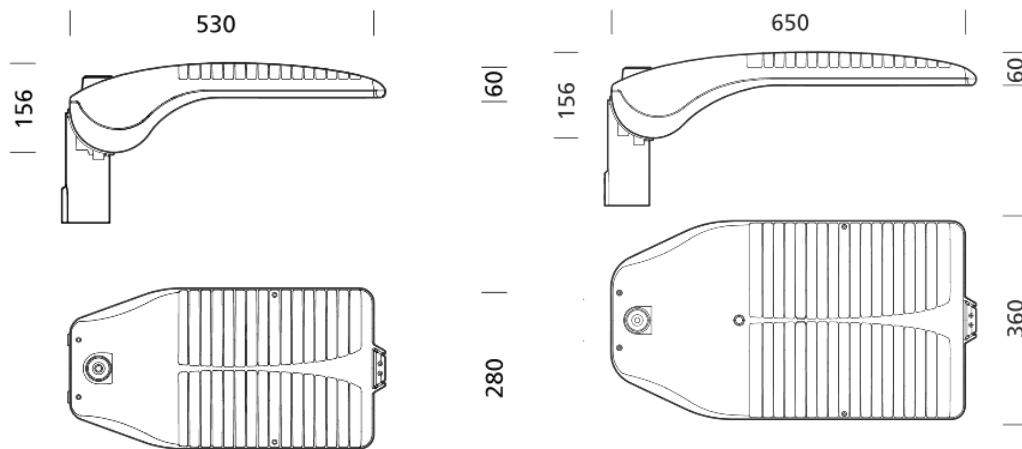

TECHNICAL SUPPORT

Tel: 0161 331 5700

E-mail: technical@whitecroftlight.com

www.whitecroftlighting.com

Please note: All images shown are for illustration purposes and should be used as a reference guide only.

GENERAL INFORMATION

1. A qualified electrician, in accordance with IEE wiring regulations, should carry out connection to mains wiring.
2. Ensure that the rated voltage and frequency requirements are compatible with the available mains supply.
3. Cleaning of reflectors and lenses should be carried out using clean, soft and lint free cloths and anti-static cleaning fluid.
4. Do not carry out high voltage insulation test, i.e. 500/1000v this may damage internal components.
5. For non-encapsulated products, for instance modules where the components can be touched, electro static discharge can damage sensitive components on the Printed Circuit Board (PCB) or LED. For this reason ESD precautions must be taken wherever these modules are handled or built in into the Luminaire.
6. When servicing luminaires on site, grounding of the service field engineer should be considered.
7. We recommend use of a high temperature copper paste on all screws that need to be accessed during maintenance process, this will prolong the life of the fixings and reduce the force required to remove the screws.
8. Some luminaires installed in outdoor environments may experience a build-up of internal condensation. This is due to a difference in temperature between inside and outside the luminaire which is quite common and acceptable under BSEN60598.



Sirocco Park & Sirocco Flood



Installation Leaflet

PK/LEAF/SIROCP

SEPTEMBER 2017 - Rev C



Whitecroft Lighting Limited

Burlington Street, Ashton-under-Lyne, Lancashire OL7 0AX
Telephone +44 (0)870 5 087 087 Facsimile: +44 (0)870 5 084 210

Registered No. 3848973 England

Registered Office: As above

The Sirocco Park and Sirocco Flood are Exterior Street lighting luminaires available in a choice of light distributions and power levels. See www.Whitecroftlight.com for full specifications of the entire range.

Nom. mounting column/bracket diameter: Ø60mm
 Max mounting column/bracket diameter: Ø63mm
 Body finish: Anthracite
 Factory-fitted Photocell switching: On 70 lux/Off 105 lux.

Luminaire	Height mm	Width mm	Length mm	Weight Kg
Sirocco Park	156	280	530	8.8
Sirocco Flood	156	360	650	12.8 max

INSTALLATION SEQUENCE

In order to fit this luminaire, the correct sequence of assembly must be observed. During installation make sure the power supply is completely isolated from the mains.

Refer to general information overleaf before installation.

1. Carefully unpack the luminaire and locate the plug kit and gland kit.
2. Prepare the body for installation in the correct orientation – on a vertical post or horizontal bracket. Remove and re-fit the mounting socket if necessary. (fig 1) If additional electrical feeds are required for Dali control, fit the supplied gland into the body mounting socket at this stage. (fig 2)
3. Fit the IP66 plug supplied to the incoming supply flex. (fig 3) Supply flex must be round and Ø9-12mm.
4. Plug the supply into the flying lead attached to the luminaire. Ensure that the connectors are locked together by rotating the locking ring.
5. If Dali feeds are to be used, they must be passed through the gland into the body. The luminaire can be opened via 4 off 4mm hex screws from above. Make Dali connections directly to the labelled terminal blocks. Close the luminaire ensuring that the IP seal is free from obstructions.
6. Fit the luminaire onto the mounting post/bracket and tighten the securing grub-screws to 8Nm. (fig 4)

NB. If a photocell is fitted, the luminaire will not switch on in daylight. Cover the sensor to simulate darkness to verify operation.

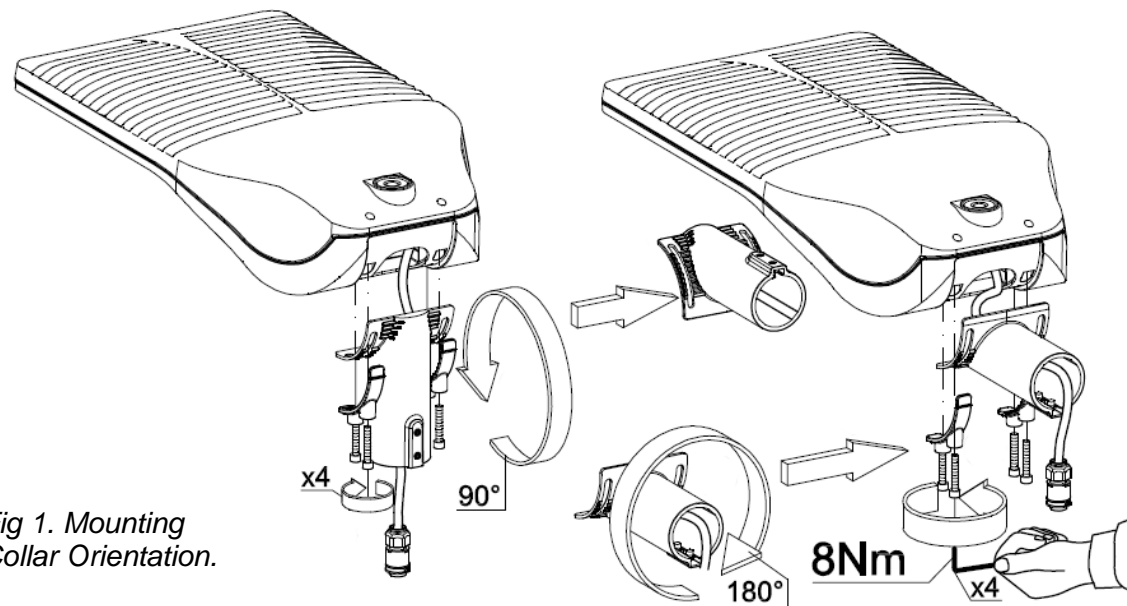

Fig 1. Mounting Collar Orientation.

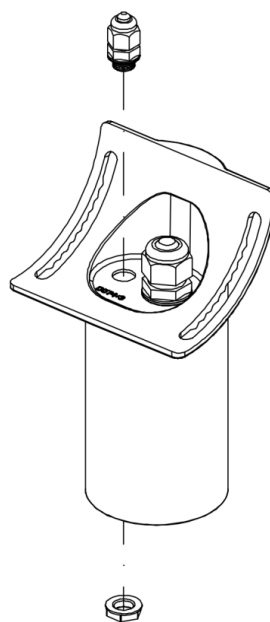

Fig 2. Knock-out or drill if required.

Fig 3. Fit Supply Plug.

1. Prepare the supply flex.
2. Pass the flex through plug body.
3. Make electrical connections.
4. Close plug – press fit together.
5. Tighten the gland-nut to seal the plug body.

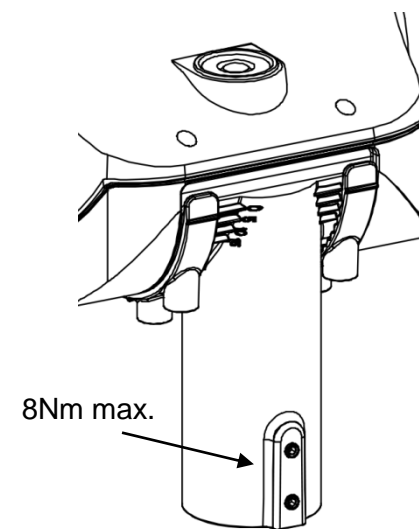
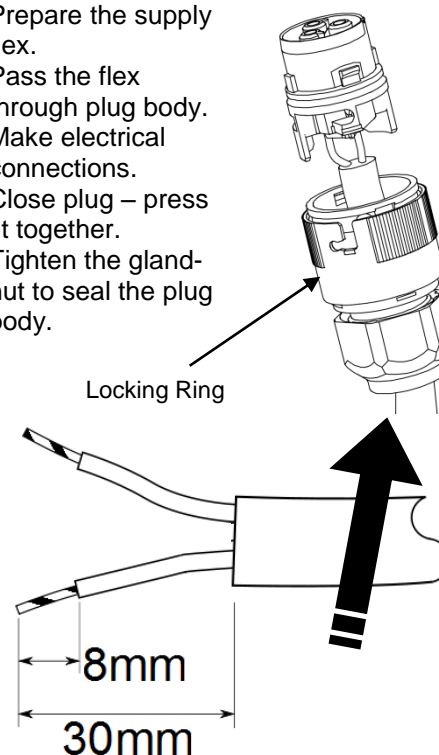

Fig 4. Mount Luminaire.