



Whitecroft  
lighting

# Data Centre Lighting

Designed to deliver

# Expertise that de-risks your project at every stage

As part of the Fagerhult Group, we bring proven expertise, built on more than 50 Data Centre projects across Europe spanning enterprise, colocation and hyperscale environments.

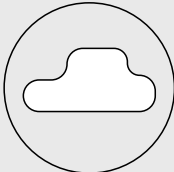

### Hyperscale

Large-scale facilities owned and operated by cloud services providers.

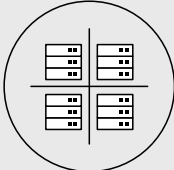

### Colocation

Facilities built with client flexibility in mind.

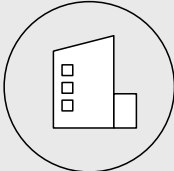

### Enterprise

Localised client-specific facility.



# Lighting engineered for Data Centres

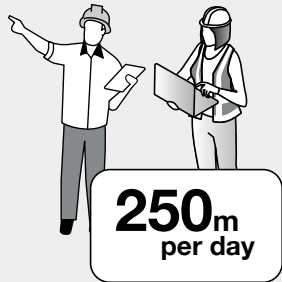

## Rapid installation

Our Light Line solution for data halls is pre-assembled, pre-tested, plug-and-play. Our two-person teams can install up to 250 metres per day – cutting time on site by up to 50%.

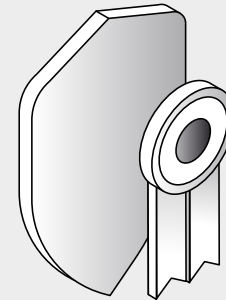

## Exceptional reliability

Because we pre-assemble the Light Line, it has fewer on-site connections and fewer points of failure. Its aluminium body provides excellent thermal management, ensuring reliable performance over time.

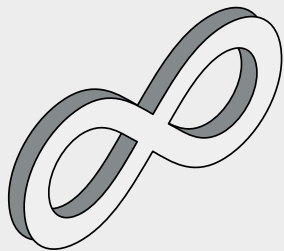

## Sustainability & circularity

Our circular design principles support your ESG targets – rooted in our own SBTi-validated net-zero journey.

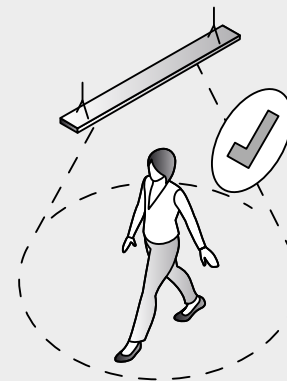

## Comfort & compliance

From initial design to final sign-off, we ensure lighting performance and compliance are built in from the start.

# Light Line: pre-assembled and ready to install



Supplied in partnership with



## Plug-and-play modularity

Pre-assembled and pre-tested sections connect instantly on site for rapid installation.

**250m**  
installed per day  
with a two-person team



## Integrated emergency lighting

Self-contained or central battery with auto-test and reporting.

## Built for regeneration

Replace or upgrade components without dismantling.

## Sensor-ready for smart control

Compatible with leading sensors and control systems.

# Built to perform in demanding white spaces

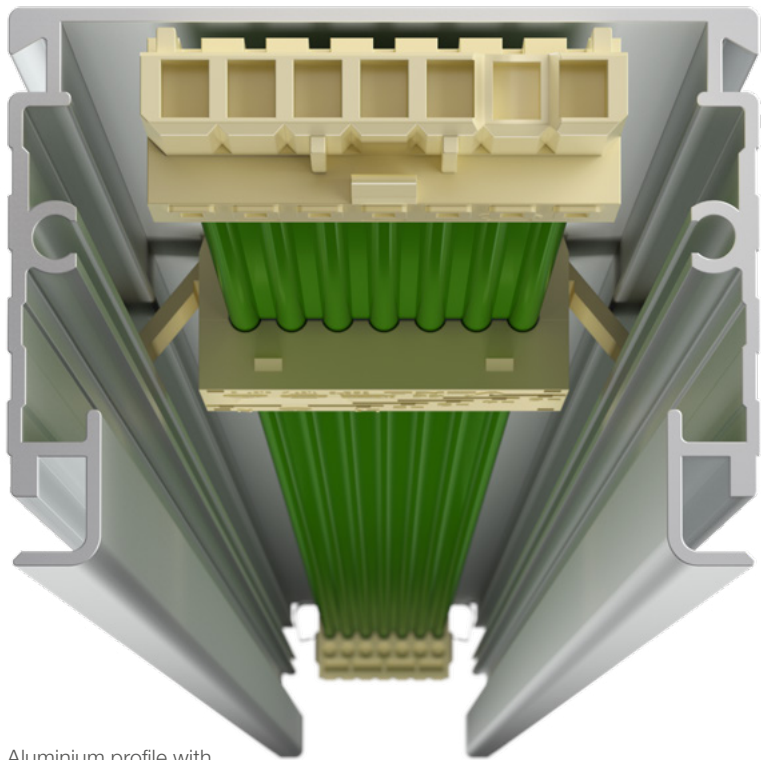

Aluminium profile with  
7, 10 or 13 cores.



## Built to handle 50°C and beyond

Aluminium trunking system delivers outstanding thermal management, reducing component stress for longer lifetime performance.

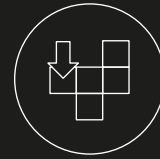

## Fewer joints, fewer failures

Pre-assembled, plug-and-play aluminium modules reduce joints and on-site connections, lowering the risk of errors or failure in demanding data hall environments.



## High-performance driver rated to 100,000 hours

Engineered for industrial environments, our driver delivers over 10 years continuous use, reducing maintenance demands and minimising downtime.

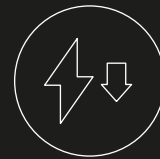

## Optimise your Power Usage Effectiveness (PUE)

Premium LEDs and precision optics deliver a low-energy lighting solution that reduces electrical load and limits thermal gain across the building.



## Recycled and recyclable

Our aluminium body is made from over 70% recycled material and provides a more sustainable end-of-life pathway than steel.

# The data hall solution

## Lighting's role in supporting PUE

Although lighting typically accounts for a small portion of a Data Centre's non-IT energy load compared to other systems, it still plays an important role in improving Power Usage Effectiveness (PUE).

By implementing high-efficiency LED luminaires, smart controls, and application driven lighting design, Data Centres can significantly reduce lighting related energy consumption.

This reduction directly lowers total facility energy use, positively influencing the project's PUE target and reinforcing an energy-conscious approach across all building services.

## High-efficacy lighting for lower energy use

Our data hall Light Line solutions use light sources rated up to **212 lm/W**, with overall luminaire efficacy exceeding **190 lm/W**. Paired with precision optics that direct light only where it's needed, this reduces waste and lowers installed load.

## Visual comfort and compliance

Maintenance teams need to carry out precise, hands-on work, often with small components and in challenging conditions.

Our lighting ensures the clarity and comfort they need, delivering consistent vertical and horizontal illumination in line with **TIA-942 requirements**, and meeting **EN 12464 standards** for uniformity, glare control, and colour rendering.

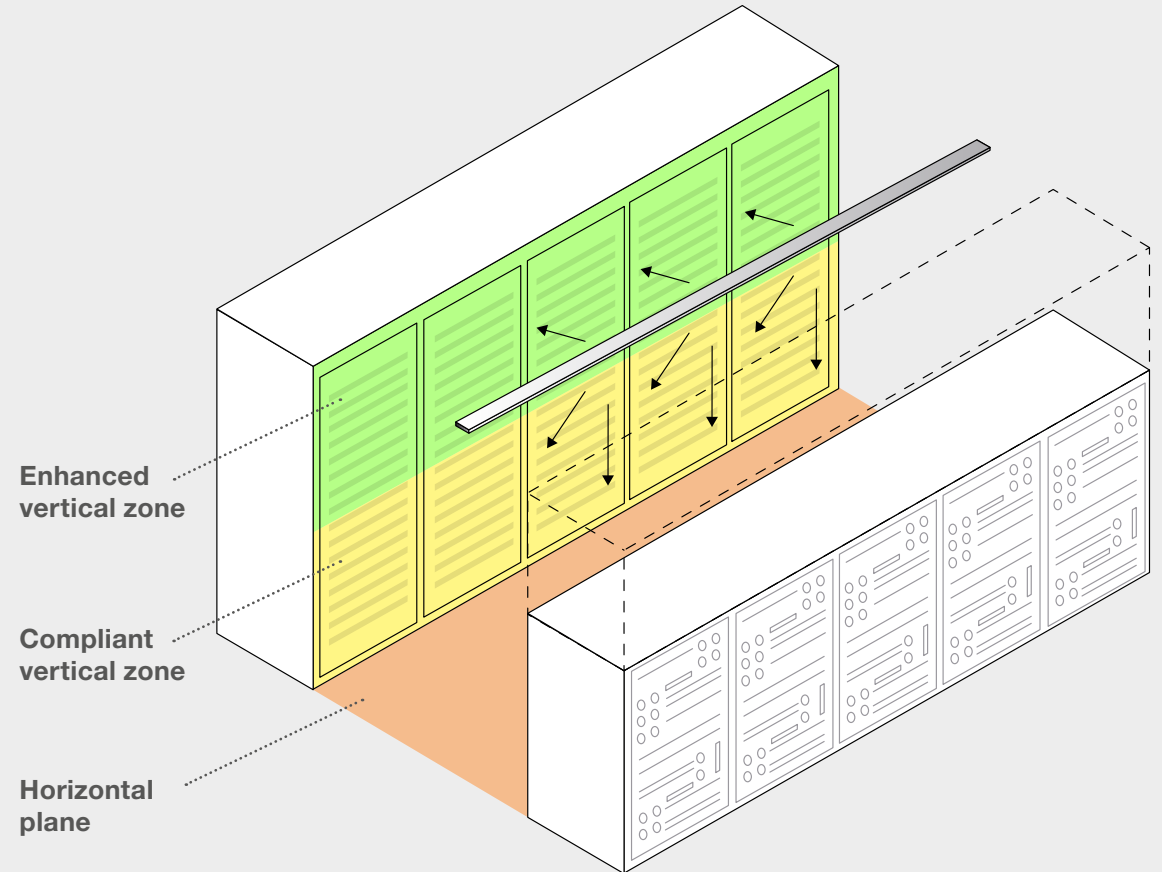

Lighting performance	
<b>Hilde Oval</b>	<b>Magnus Diffuser</b>
500 lux	500 lux
200 lux	500 lux
✓	✓✓✓
10 W / metre	24 W / metre

# Hilde Oval

Optimised light distribution with UGR <22 for lowest energy

Delivers exceptional vertical illumination and broad, even light coverage to enhance visibility across server racks and equipment positioned at higher levels. This ensures a consistent and well-lit environment that supports efficient monitoring and maintenance activities. A cost-effective solution for general data hall applications, delivering high performance without exceeding budget constraints.

Supports premium PUE performance

Up to 50% energy savings over wide-beam solutions

Ultra-efficient lens-based optic

Meets horizontal and vertical illuminance requirements

Low-glare UGR <22 compliance

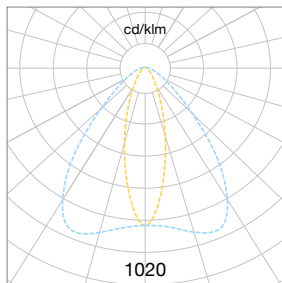

- 29.5W
- 5500 lm
- Will achieve 500 lux on the floor of a data hall aisle using 3m axial spacing

Supplied in partnership with



# Magnus Diffuser

Visual comfort with exceptional vertical illuminance

Exceptional broad, even coverage, ideal for environments where higher levels of vertical illuminance are key. A cost-effective, solution for general data hall applications.

500 lux on both horizontal and vertical planes

Superior performance across wider aisles

Homogeneous lit effect enhances visual comfort

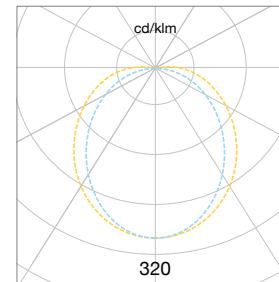

- 73W
- 11500 lm
- Will achieve 500 lux on the floor of a data hall aisle using 3m axial spacing

Supplied in partnership with



# Total partnership, total project solution

From early design consultancy to handover, our team ensures seamless, de-risked lighting across every project stage, every zone and every application area. One lighting partner, one source of certainty for your white and grey spaces.

## Rooftop services

Robust, weatherproof lighting that supports safe maintenance.

## Operational support areas

Functional lighting solutions to support the core operation of the facility.

## Data hall

Integrated lighting system that effectively lights both horizontal and vertical planes to help optimise Data Centre operation and maintenance.

## Administration areas

Compliance with EN 12464 for all workspace areas, with comfort and visual clarity at the forefront of design.

## Outdoor

Enhancing the building's architecture with light while supporting safety and security.

# From proven products to seamless delivery

We manage design, controls, commissioning and aftercare through a single point of contact – ensuring every element works together and your project runs smoothly from specification to handover.

## Outdoor



**Mistral**  
Robust post-top luminaire for parking areas.



**Kolo Bollard**  
Robust and weatherproof versatile LED bollard.



**Atra**  
Building perimeter lighting bulkhead designed to protect dark skies.

## Rooftop services



**ACL Xtreme**  
Surface-mounted linear luminaire with high UV resistance.



**Kolo IP65 Hood**  
Robust surface bulkhead with visual interest.



**Euroflood**  
Adjustable floodlight with versatile optic.

## Administration areas



**Cascade**  
Modular recessed luminaire with replaceable low-glare optic.

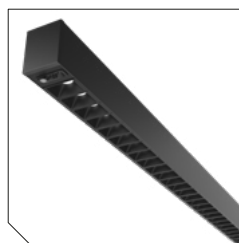

**Avenue**  
Continuous suspended system with direct and indirect light.



**Mirage 3**  
Downlighter for functional and feature lighting.

## Operational support areas



**Triepak**  
Efficient, easy to install LED batten for general lighting.



**ACL Industry**  
IP65 anti-corrosive surface luminaire.

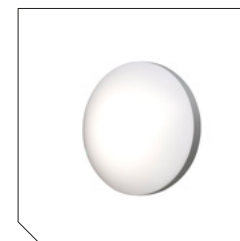

**Horizon 360**  
Versatile bulkhead for interior applications.

# Sustainable by design, for today and tomorrow

Our lighting system is built to perform now and protect resources for the future – engineered for energy efficiency, material circularity and long-term value that supports your ESG goals.

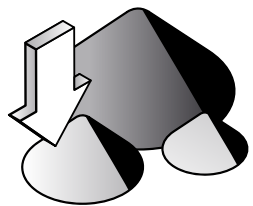

## Reduce material content

We don't add materials you don't need. Our system is configurable with 7, 10 or 13 conductors, so you only get what your project requires. Whether you're looking to future-proof or minimise material use, we deliver a solution that's **efficient by design**.

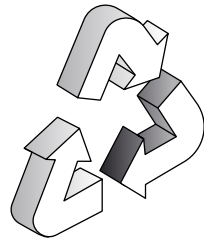

## Reduce virgin material usage

The aluminium body is made from **over 70% recycled content**, significantly reducing embodied carbon compared to virgin-material alternatives and ready to recycle when the time comes.

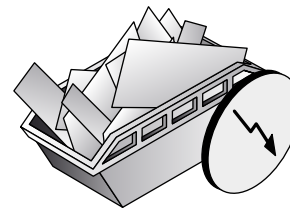

## Reduce material waste

Delivered pre-assembled, our solution reduces on-site time and arrives with **minimal packaging** – no excessive wrap, no unnecessary waste. Just ready-to-lift, ready-to-fit modules that make installation cleaner, faster, and more sustainable.



## Choose partners who go further

We've joined the **Science Based Targets initiative (SBTi)** to back our sustainability ambitions with globally recognised standards. For you, it means confidence that every solution we deliver **supports your carbon goals, aligns with your values,** and strengthens your own sustainability credentials.

# Circularity as standard

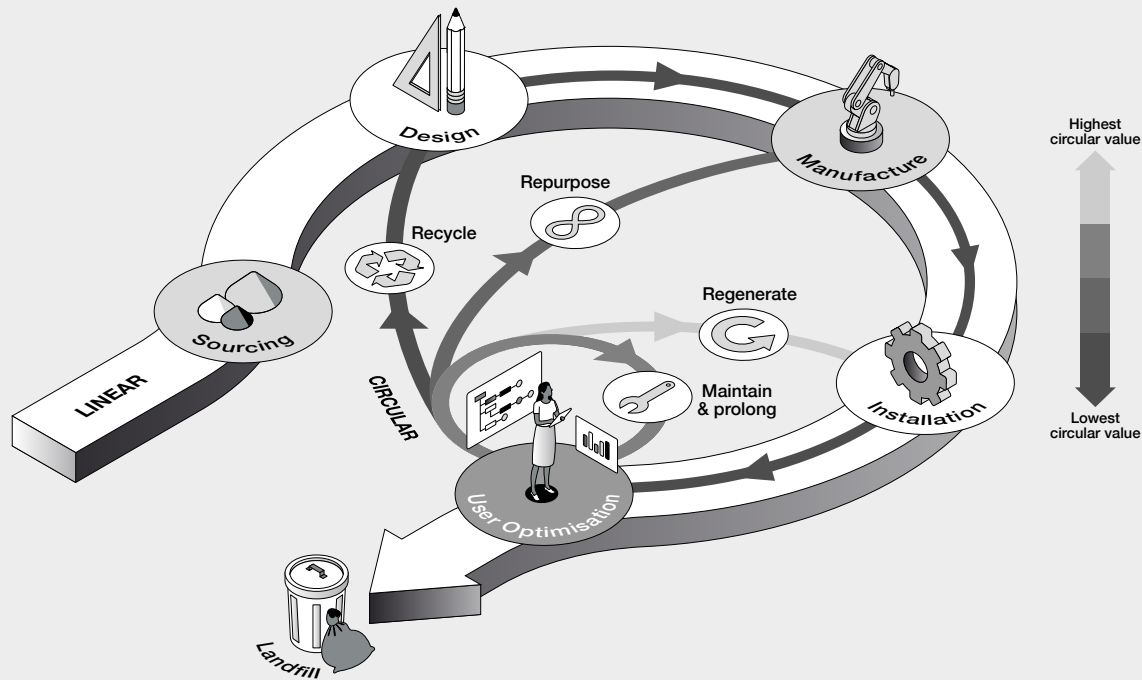

Our approach to **circular design** means luminaires are **modular**, **upgradeable** and **repairable**.

## Maintain and prolong

Designed for easy and effective maintenance, with replaceable components and robust materials that extend product life and reduce failure rates.

## Regenerate

Our modular luminaires can be refurbished and reconfigured with new controls, optics or gear trays. This restores performance without replacing the entire fitting.

## Repurpose

Thanks to their standardised form and click-in architecture, our luminaires can be moved or reassigned to new locations within the same building or elsewhere. This supports adaptive reuse strategies.

## Recycle

At end-of-life, luminaires are designed to be easily separated into recyclable parts. Our aluminium bodies are 100% recyclable and support closed-loop recovery.

# Lighting controls to suit every need

From standalone presence detection to advanced system-wide integration, our scalable controls are easy to integrate, simple to manage, and built to support energy efficiency, compliance and operational resilience from day one.

## Organic Response®

### Wireless controls

Installation and commissioning	✓	✓	✓	✓	✓
Energy-saving	✓	✓	✓	✓	✓
Flexibility and future-proofing	✓	✓	✓	✓	✓

Organic Response works straight out of the box with instant energy savings. With simple app access and optional cloud integration, it scales from room-level efficiency to full estate insight.

- Up to 40% energy savings from day one.
- Simple app setup for setback lighting and timed presence control.
- Centralised emergency testing and reporting.
- Seamless BMS integration for HVAC, blinds and security.
- Real-time energy insight, compliance support and building-wide control via the Response Portal.

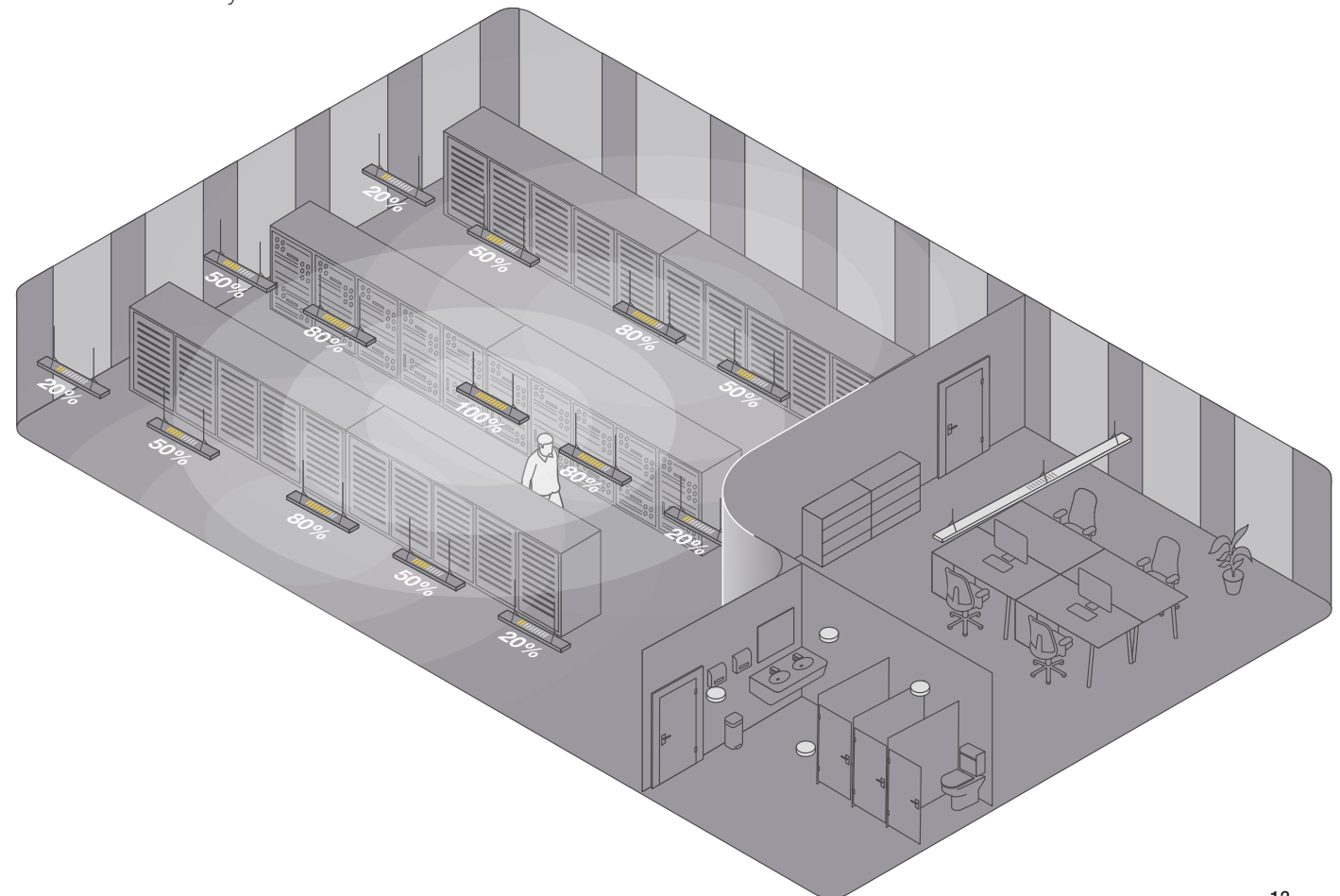

All our connected systems meet **ISO 27001** and **EU RED Directive standards** – ensuring robust cybersecurity, data integrity and reliable wireless performance from day one.

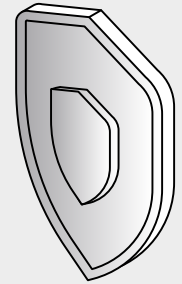

 [Find out more here](#)

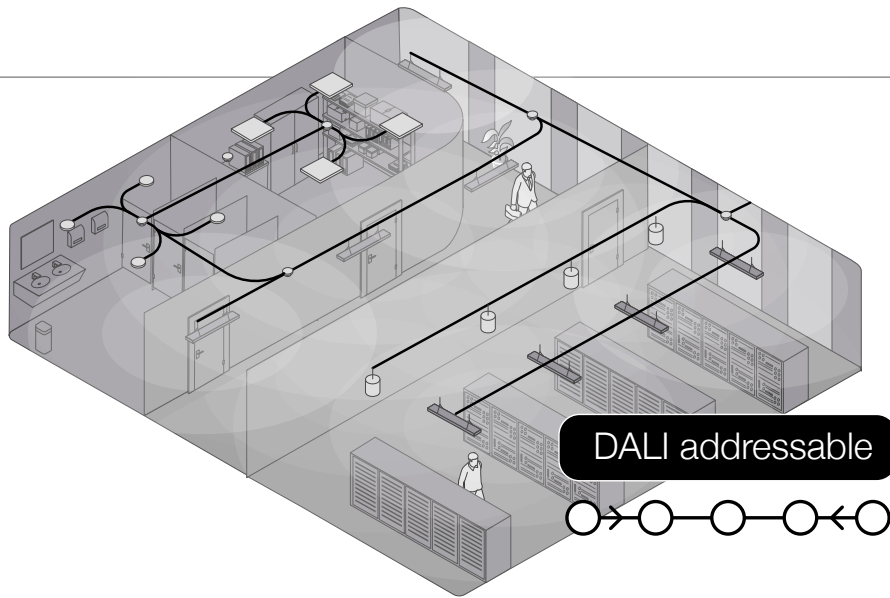

## Whitecroft Connect

DALI-2 wired

Installation and commissioning	<input checked="" type="checkbox"/>	<input checked="" type="checkbox"/>	<input checked="" type="checkbox"/>	<input checked="" type="checkbox"/>	<input checked="" type="checkbox"/>
Energy-saving	<input checked="" type="checkbox"/>	<input checked="" type="checkbox"/>	<input checked="" type="checkbox"/>	<input checked="" type="checkbox"/>	<input checked="" type="checkbox"/>
Flexibility and future-proofing	<input checked="" type="checkbox"/>	<input checked="" type="checkbox"/>	<input checked="" type="checkbox"/>	<input checked="" type="checkbox"/>	<input checked="" type="checkbox"/>

Open-protocol detector designed for seamless integration with compatible systems, using pre-installed Light Line cabling for simple, plug-and-play connection.

- Two-way communication with head-end control software.
- Automated emergency testing and digital reporting.
- Central status monitoring to support maintenance and energy logging.
- Scene setting to optimise user comfort, building operation and energy.

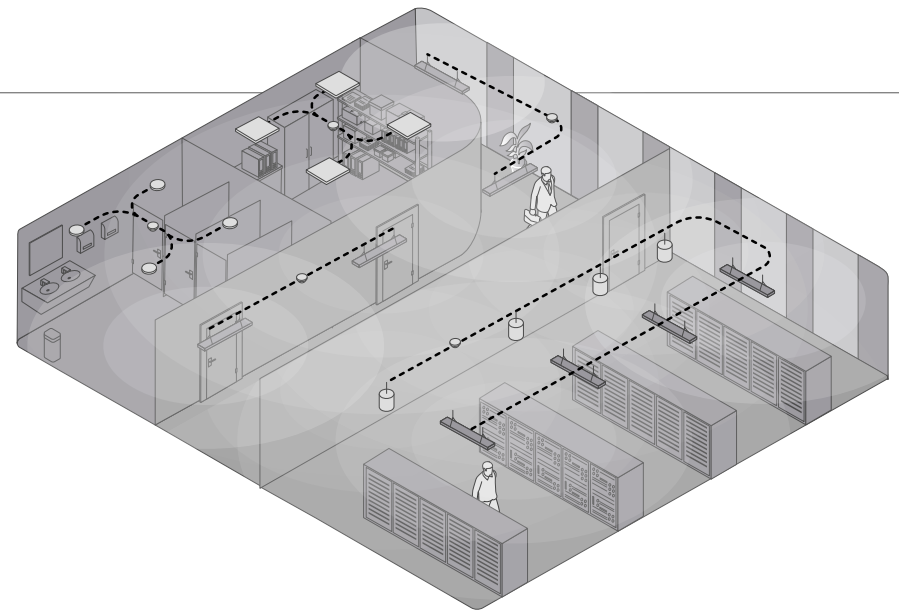

## Whitecroft Sense

Standalone detectors

Installation and commissioning	<input checked="" type="checkbox"/>	<input checked="" type="checkbox"/>	<input checked="" type="checkbox"/>	<input checked="" type="checkbox"/>	<input checked="" type="checkbox"/>
Energy-saving	<input checked="" type="checkbox"/>	<input checked="" type="checkbox"/>	<input checked="" type="checkbox"/>	<input checked="" type="checkbox"/>	<input checked="" type="checkbox"/>
Flexibility and future-proofing	<input checked="" type="checkbox"/>	<input checked="" type="checkbox"/>	<input checked="" type="checkbox"/>	<input checked="" type="checkbox"/>	<input checked="" type="checkbox"/>

This wired, standalone control option uses discrete sensors that clip directly onto the Light Line profile. Once connected to power, each sensor functions immediately, managing local groups of luminaires without extra cabling.

- Presence/absence detection – lights on when someone enters, off when empty.
- Daylight dimming – save energy by balancing natural light.
- Scene setting – low-level setback for periods of low occupancy or to maintain background security lighting.
- Fast commissioning via setup app.
- IP55 rated – dust and splash resistant.

# Emergency lighting

## Exit signage and escape route lighting



Our emergency exit signage can be **trunking, wall or ceiling mounted** to suit any layout. Combined with Florin modules within the Light Line system, escape routes are clearly illuminated for safe evacuation and compliance with emergency lighting standards.

### Option 1

#### Self-contained emergency lighting

- Advanced LiFePO4 battery with 8-year design life.
- Independent operation – no single point of failure.
- Simple maintenance – replace or test individual units with ease.
- Ideal for smaller or distributed installations.

### Option 2

#### Central battery emergency lighting

- Single power source serving multiple luminaires via trunking.
- Remote monitoring and simplified maintenance.
- Higher emergency light levels achievable for large or critical areas.
- No fire-rated cabling required – trunking acts as a protected conduit, cutting installation cost and complexity.

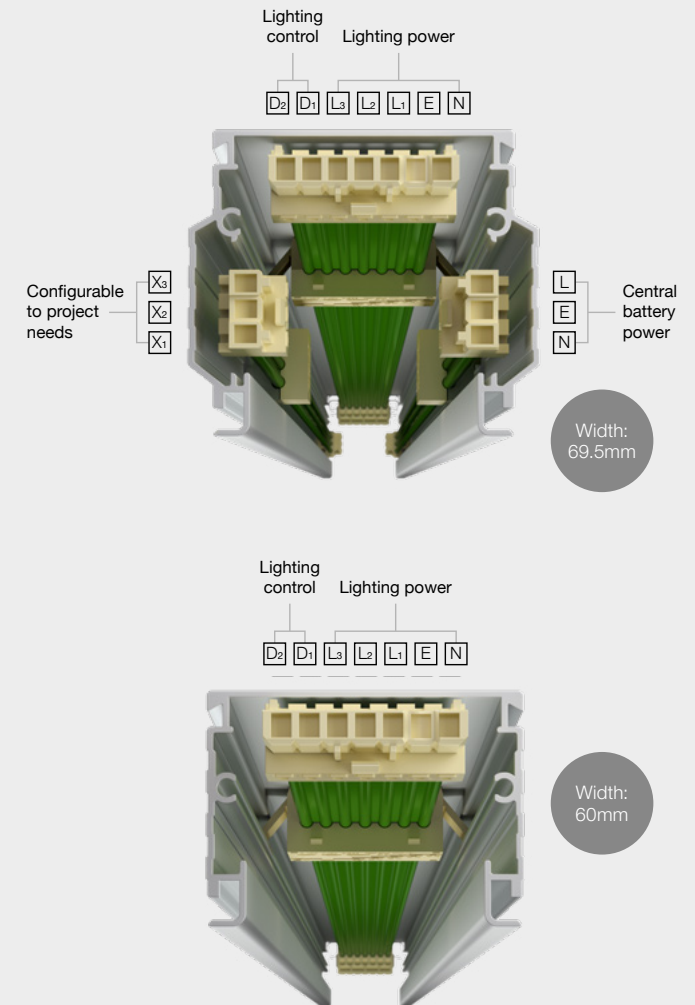

## 7, 10 and 13 core Light Line trunking

Available in 7, 10 and 13 core configurations to support power, control and emergency circuits within a single modular system. Pre-wired for fast installation and flexible project design.

## Standard Veko Light Line range – IP50 4000K

- Light Line’s modular system allows you to combine different lengths, infills and lumen packages to create the exact trunking configuration your project needs.
- The lengths and lumen packages in the table below have been defined for typical range of data hall aisles and circulation areas.
- Our design and production facilities allow for customised lengths (up to 6m), lumen outputs (up to 20,000 lm) and optical configurations to match project requirements. For bespoke specifications, contact sales.

Lumens	Wattage	Diffuser	DALI driver			DALI driver and self-contained emergency			DALI driver and central battery emergency		
			Organic Response	Connect	Sense	Organic Response	Connect	Sense	Organic Response	Connect	Sense
5500 lm	29.5W	Hilde Oval	•	•	•	•	•	•	•	•	•
11500 lm	73W	Magnus Diffuser	•	•	•	•	•	•	•	•	•
3000 lm	16W	Hilde Oval	•	•	•	•	•	•	•	•	•
3000 lm	19W	Magnus Diffuser	•	•	•	•	•	•	•	•	•

4.59m Light Line with central infill



3.06m Light Line



4.59m Light Line with central luminaire



1.53m Light Line



## Light Line accessories

Coupler kit  
– side fix (pair)



Coupler kit –  
top fix (pair)

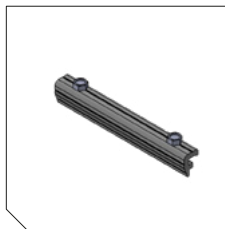

End power  
feed 7 core

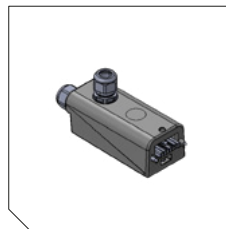

End power feed  
10 or 13 core

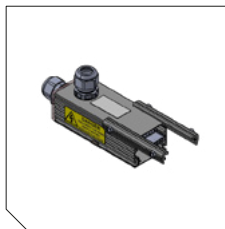

Centre-feed unit  
7, 10 or 13 core

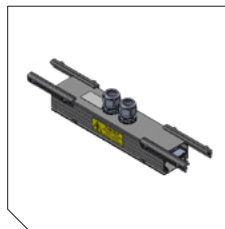

Wire suspension  
bracket – clip-on

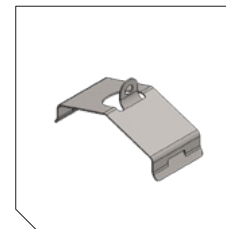

Rod-suspension  
bracket

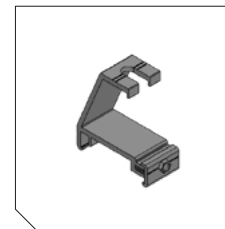

Surface-suspension  
bracket

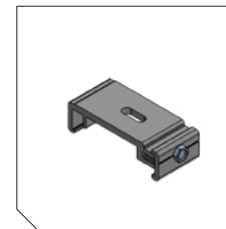



**UK Head Office**

Whitecroft Lighting Ltd  
Burlington Street  
Ashton-Under-Lyne  
Lancashire  
OL7 0AX

T +44 (0)161 330 6811  
email@whitecroftlight.com

**London Office**

Whitecroft Lighting Ltd  
Suite 779 Salisbury House  
London Wall  
Finsbury Circus  
EC2M 5SQ

T +44 (0)161 330 6811

**Rep. Ireland Office**

Fagerhult Ltd  
F1 Calmount Park  
Ballymount, Dublin 12  
Ireland

T +353 (0)1 426 0200  
info@fagerhult.ie  
www.fagerhult.ie

