

# Product Data Sheet

## iDim Sense (System & Standalone)

iDim

315

The iDim Sense is a luminaire-based DALI sensor. It combines a movement detector (PIR), remote control receiver (IR) and photocell (CL) in one enclosure and a manual mode selector which allows the user to easily select one of the 6 out-of-box application modes. It also benefits from additional system functionality when used with DIGIDIM Toolbox and Helvar 910/920 Router systems.

### Key Features

- PIR, Constant Light and Infrared control
- Easy to select application modes
- Clip-on fascia in different colours
- Clip-on PIR Restrictor
- Mode selector with LED feedback
- Network compatible with DIGIDIM Toolbox and Helvar 910/920 Router systems

### Installation Notes

- Multiple mounting options:
  - 1) Mount from outside luminaire. "Click fit"
  - 2) Mount from inside luminaire. "Bracket fit"
  - 3) Combined with a louvre adapter. "Adapter fit"
- Isolate the mains supply before installation
- DALI cabling must be 230 VAC mains rated

### Recommended Mounting Location

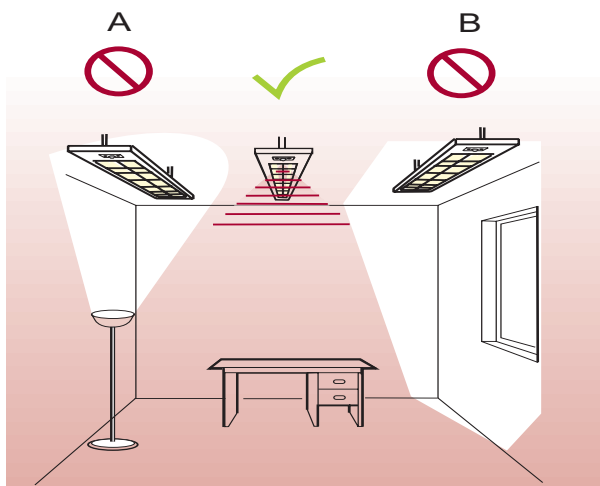

- A) Do not mount sensor in direct line of artificial light sources e.g. lamps, uplighters.  
B) Do not mount sensor in direct sunlight

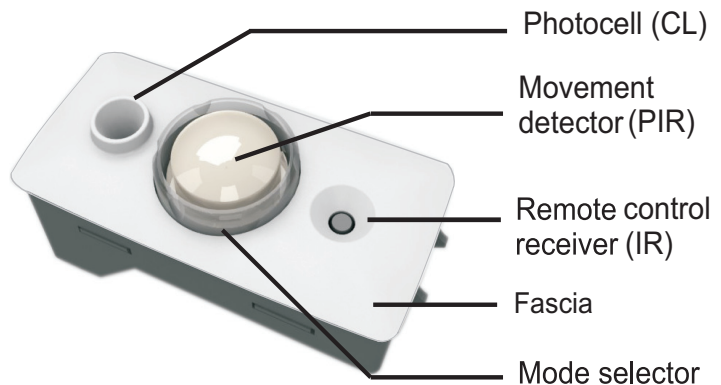

### PIR Coverage

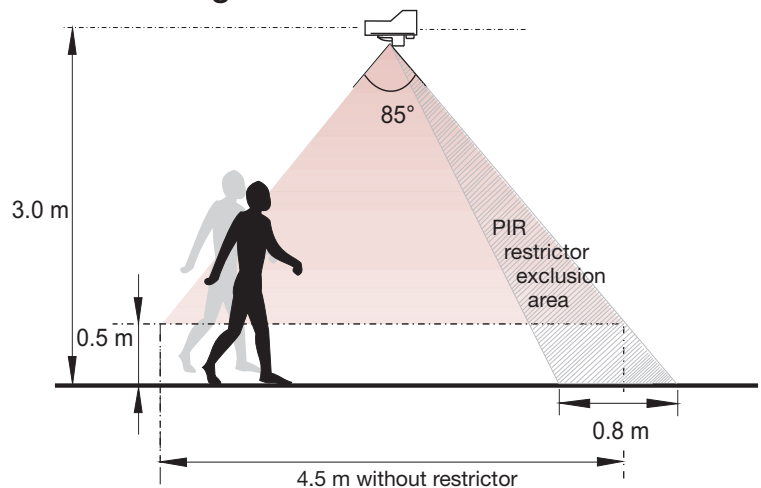

### Constant Light Coverage

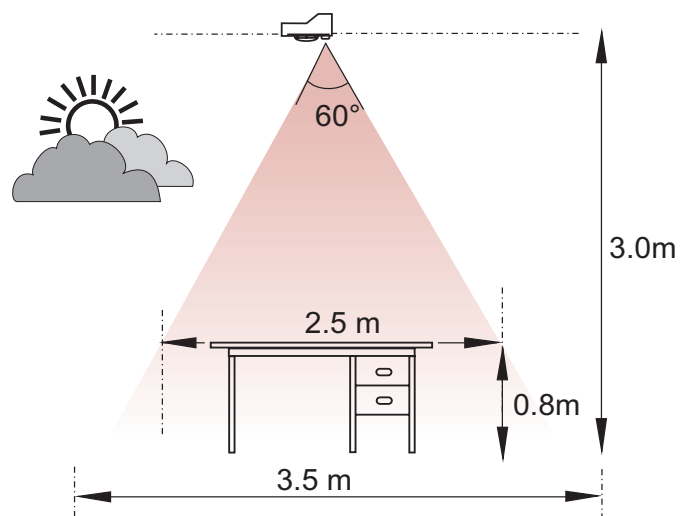

**Helvar**  
www.helvar.com

# Product Data Sheet

## iDim Sense (System & Standalone)

iDim

315

### Connections

DALI:	Removable connector block Wire size: 0.5 mm <sup>2</sup> - 1.5 mm <sup>2</sup> Stripped 9mm Solid, flexible or stranded
iDim Solo:	RJ Style 4P4C crossover Max. length 3 m (accessory cable available)
Power cable rating:	All cables must be mains rated

### Power

DALI Consumption:	10 mA
-------------------	-------

### Mechanical Data

Dimensions (L x W x H):	
Unit without fascia:	55 mm x 25 mm x 20 mm
Unit with fascia:	58 mm x 28.5 mm x 21.4 mm
Material (casing):	Non flammable ABS (UL94-V0 & UV resistant)
Colour: iDim Sense:	White (RAL 9016)
iDim Fascia:	White (RAL 9016) or Grey (RAL 9006)
Contact Helvar for additional Fascia colour options	
Weight:	15 g
Recommended	
Luminaire Thickness:	0.6 mm to 2.4 mm
Lux level:	5 - 5000 lx
IP rating:	IP30

### Operating Conditions

Ambient Temperature:	10°C to 50°C
Relative Humidity:	Max 90%, non-condensing
Storage Temperature:	-25°C to +75°C

### Conformity and Standards

DALI:	According to DALI standard, with Helvar extensions
EMC:	
Emission	EN 55 015
Immunity	EN 61 547
Safety:	EN 61 347-2-11
Isolation:	Double isolated
Environment:	Complies with WEEE and RoHS directives

### Connections

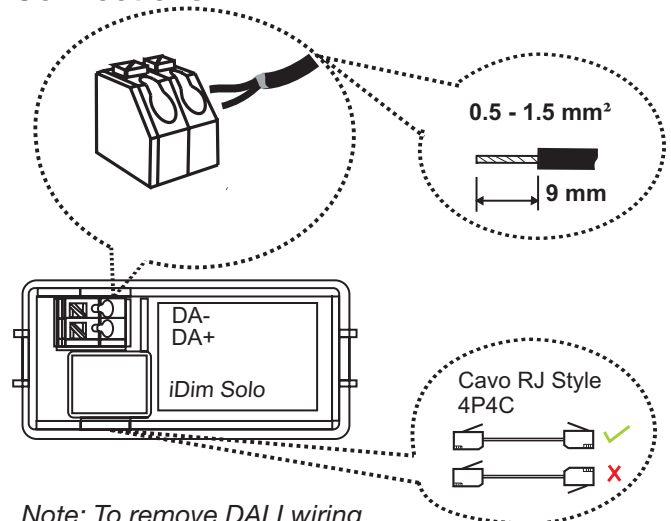

Note: To remove DALI wiring, always press down on the push wire connector clips

### Dimensions (mm)

iDim Sense without fascia

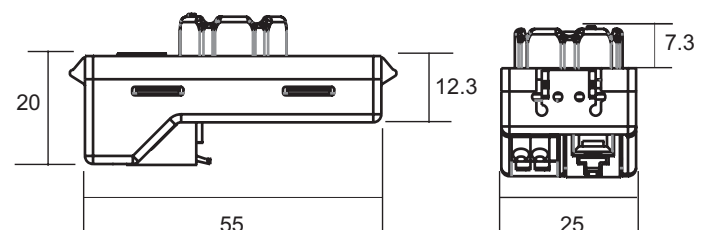

iDim Sense with fascia

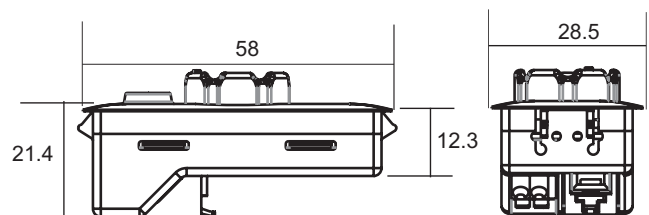

Movement detector (PIR), remote control receiver (IR) and photocell (CL)

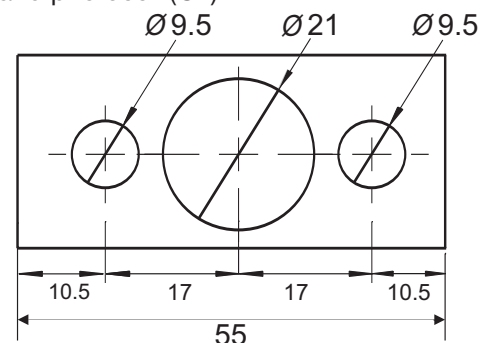

**Helvar**  
www.helvar.com