

SPECIFICATION

Foil Solo LED is supplied as 2200mm long bodies in widths of 500 & 700mm and with acoustic material depths of 30 or 46mm. Luminaires can be individually or continuously mounted & come complete with segregated wire ways for additional service cabling. Foil Solo LED uses a positively retained permanently fixed diffuser optic producing a 60% down, 40% up light distribution. Foil Solo is supplied with an individually adjustable wire suspension kit and clutch retention system for direct ceiling mounting & levelling. Infill panels are available in various sizes for continuous mounting & luminaire spacing as appropriate

Finish:	Luminaire	- Silver RAL 9006 30% gloss polyester powder-coat. - White RAL 9010 30% gloss polyester powder-coat
	Canopy/Gear Tray	- White RAL 9003 30% gloss polyester powder-coat.
Materials:	Foil Wing	- 0.9mm micro perforated mild steel
	Canopy/Gear Tray	- 0.7mm mild steel.
	Diffuser	- 3mm Micro Prism Acrylic within mild steel frame.
	Acoustic	- 80Kg/m ³ Tissue wrapped compressed fibreglass.
Control Gear:	Fixed Output / DALI control gear as specified.	
Led Options:	1200mm High or Low Output LED / 1500mm High or Low Output LED	
Operating Temp:	25 °C	
Supply:	240V	
Connection:	Unfused 2.5mm terminal block	
IP Rating:	IP20	

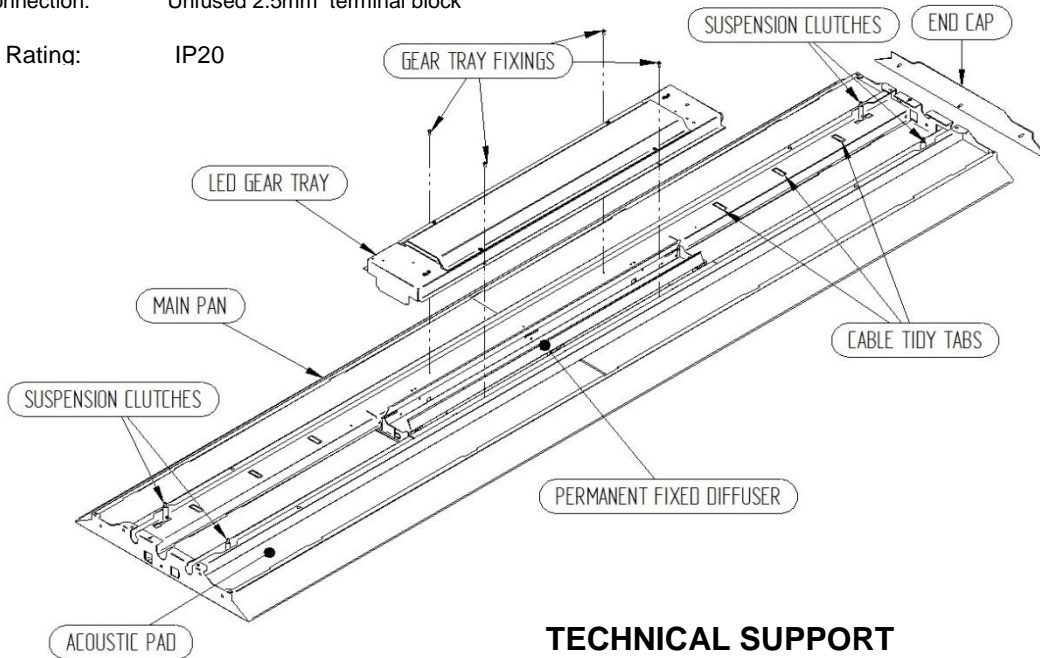

Exploded Isometric for illustration purposes only.

TECHNICAL SUPPORT
Telephone: 0161 331 5700
E-mail: technical@whitecroflight.com
<http://www.whitecroflight.com>

Whitecroft
lighting

FOIL single optic

LED OPTION DIFFUSER



SUSPENDED ARCHITECTURAL LUMINAIRE Installation Instructions

JULY 2012 - Rev B



Whitecroft Lighting Limited

Burlington Street, Ashton-under-Lyne, Lancashire OL7 0AX
Telephone +44 (0)870 5 087 087 Facsimile: +44 (0)870 5 084 210

Registered No. 3848973 England

Registered Office: As above

GENERAL INFORMATION

1. A qualified electrician, in accordance with IEE wiring regulations, should carry out connection to mains wiring.
2. This luminaire must be EARTHED.
3. Ensure that the rated luminaire voltage and frequency requirements are compatible with the available mains supply.
4. Cleaning of the reflectors and lenses should be carried out using clean, soft and lint free cloths and anti-static cleaning fluid.

Warning: The LEDs in this luminaire operate at HIGH VOLTAGE. Ensure that the luminaire is isolated before opening.



PRODUCT DIMENSIONS (All dimensions are in 'mm'.)

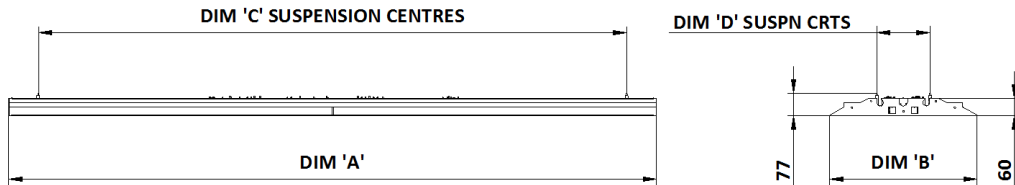

TYPE	DIM A	DIM B	DIM C	DIM D	STD WEIGHT	EM WEIGHT
1200mm LED	2200	700 or 500	2000	180	22.5kg (700)	23.5kg (700)
1500mm LED	2200	700 or 500	2000	180	23.5kg (700)	24.5kg (700)
400INFILL	400	700 or 500	200	180	3.8kg (700)	n/a
800INFILL	800	700 or 500	600	180	7.5kg (700)	n/a
1200INFILL	1200	700 or 500	1000	180	11.3kg (700)	n/a

Type	1200 Low Output	1200 High Output	1500 Low Output	1500 High Output
Power	33W	54W	41W	65W

INSTALLATION DETAILS

1. Remove the luminaire from the packaging and check the contents:-
 - 1 x Foil Solo Fitting
 - 1 x Continuous mount kit:-
 - 3 x screws & 3 x nuts.
 - 1 x Cable Gland kit:-
 - 2 x glands & 2 x locknut

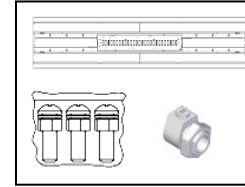

2. Remove the Suspension kit from packaging & check the contents:- (supplied separately)
 - 4 x Clutches
 - 4 x Suspension wires
 - 4 x Ceiling attachments
 - 4 x Wire mount collar

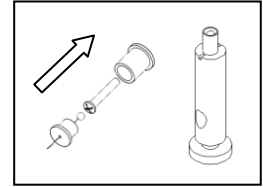

3. Set out & mark the suspension centres on ceiling surface making reference to the attached table. Spacing of fixings between all adjacent luminaires or infill's is 200mm. Secure the ceiling attachment collars using a suitable screw into a metal anchor or similar (**NB** refer to table for weights – screws & anchors not supplied). Fit suspension wires through the hole in wire mount collar & screw into the ceiling attachment. Feed a suspension clutch onto each of the suspension wires & roughly level to a satisfactory working height. Clutches are adjusted by depressing the button on top of the clutch. **NB** Ensure the luminaire weight is fully supported when adjusting clutches once luminaire is suspended.

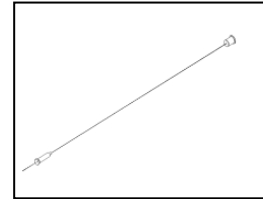

4. Support the weight of the luminaire at each end. Insert each of the four suspension clutches into the suspension slots in the rear face of the luminaire by offering them up to the slots at a 45 degree angle and then pressing down until the groove engages with the slot.

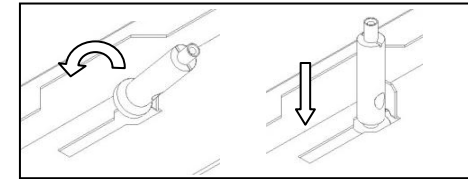

5. Slide the clutch down to the centre of the slot away from the opening until the suspension wire is hanging vertically. **CRITICAL** – Retain the clutch within the slots by folding down the small tab flat to prevent the clutch from slipping out. The luminaire can now be levelled to the required height. (Note: A minimum of 300mm from the ceiling surface should be left for access maintenance and up light distribution.)

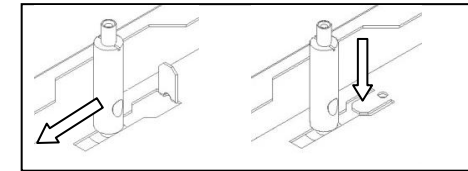

6. If securing to a wall, use the holes provided on the end flange and fix in place with screws.(not supplied) Do not remove acoustic inserts to aid this as damage may occur. To access holes, carefully push insulation to one side.

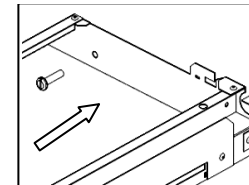

7. Should an infill be required, ensure the luminaires either side are in place first. Fold the tabs on the infill at 90° & hook onto the luminaire either side.

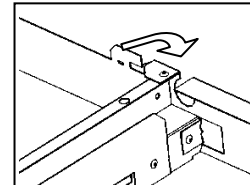

8. Secure bodies together with fixings supplied. Ensure that the arrows on the rear face are aligned opposite as shown. Do not remove acoustic inserts as per note 6.

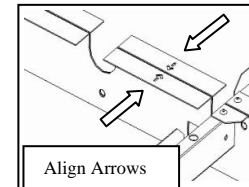

9. Remove the four screws securing the gear tray. Turn over to access terminal blocks & fit the cable glands. Feed the power cable through the gland & connect to terminal block. Screw down strain relief gland to secure cable and refit geartray ensuring all earth leads are securely attached.

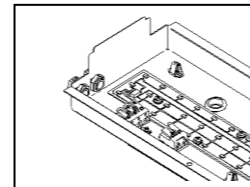

10. Attach the end cap on the end of rows or where required, using the 3 mounting holes and the nuts provided. Do not remove acoustic inserts as per note 6.

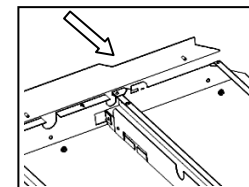

NB Access to geartray for maintenance purposes once installed is from rear face only by removing geartray assembly as note 9 above. Ensure that luminaire is isolated before opening.