

GENERAL INFORMATION

1. A qualified electrician, in accordance with IEE wiring regulations, should carry out connection to mains wiring.
2. Ensure that the rated voltage and frequency requirements are compatible with the available mains supply.
3. Cleaning of reflectors and lenses should be carried out using clean, soft and lint free cloths and anti-static cleaning fluid.
4. Do not carry out high voltage insulation test, i.e. 500/1000v this may damage internal components.
5. This product is class 2 insulated and so does not require an earth connection.
6. Some luminaires installed in outdoor environments may experience a build-up of internal condensation. This is due to a difference in temperature between inside and outside the luminaire which is quite common and acceptable under BSEN60598.
7. Replacing the light source within this luminaire shall only be carried out by the manufacturer, service agent or a similar qualified person.

Please note: All images shown are for illustration purposes and should be used as a reference guide only

TECHNICAL SUPPORT

Tel: 0161 331 5700

e-mail: technical@whitecroftlight.com

www.whitecroftlighting.com



Micro Spot 65 Installation Leaflet



PKLEAFMCRSPOT65

Mar 2016 - Rev B



Whitecroft Lighting Limited

Burlington Street, Ashton-under-Lyne, Lancashire OL7 0AX

Telephone +44 (0)870 5 087 087 Facsimile: +44 (0)870 5 084 210

Registered No. 3848973 England

Registered Office: As above

SPECIFICATION

Lamp Type: LED

Lamp Colour: 3000K (4000K On Request)

Control Gear: Fixed Output

Rating: IP65 / IK08

Body: Die cast aluminium

Diffuser: 4mm Tempered Glass

Paint Finish: Polyester powder-coated

Power: 220-240V / 50-60Hz

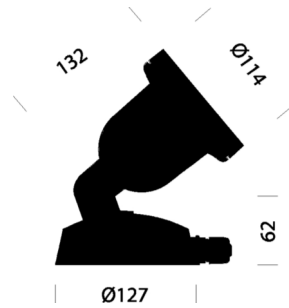

Description	Output (Llm)	Weight	Product Colour
Surface LED	1250	0.8 Kg	Grey
Surface LED	1250	0.8 Kg	Silver
Ground Mounting Spike	N/A	0.1 Kg	Black

INSTALLATION SEQUENCE

In order to fit this luminaire, the correct sequence of assembly must be observed.

All measurements in mm unless stated otherwise

1. Remove the fitting from all of the packaging.
2. Remove the central fixing screw in order to access the internal components and mounting holes (Fig. 1).
3. Surface mounting: Secure the base to the desired surface using appropriate fixings (by others) via the surface mounting holes (Fig. 2).
Optional Ground spike mounting: Secure the base to the mounting spike (if specified) using the screws provided via spike mounting holes (Fig. 2).
Optional Secure the mounting spike (if specified) into the ground and adjust the spotlight angle to achieve the desired direction.
4. Feed the 2 core supply flex (Ø 9 min - 12 max) through the 1/2" grommet (Fig. 3).
5. Strip the correct length of wire and neatly connect the 2 core supply flex to the Live/Neutral (Fig. 4) before clamping it tight using the screw fastening (Fig. 5).
6. Re-attach the base cover plate to the base using the central fixing screw (Fig. 1).

Fig. 1

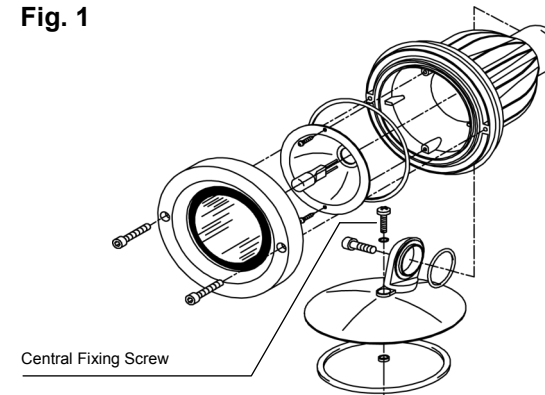

Central Fixing Screw

Fig. 3

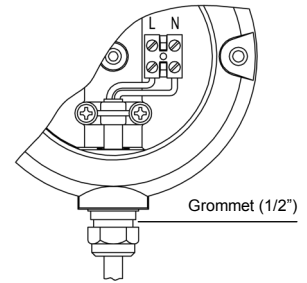

[Supply Flex Routing]

Fig. 4

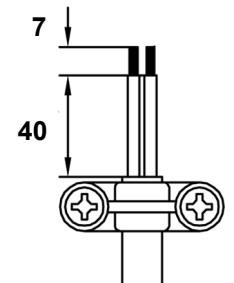

[Wire Preparation]

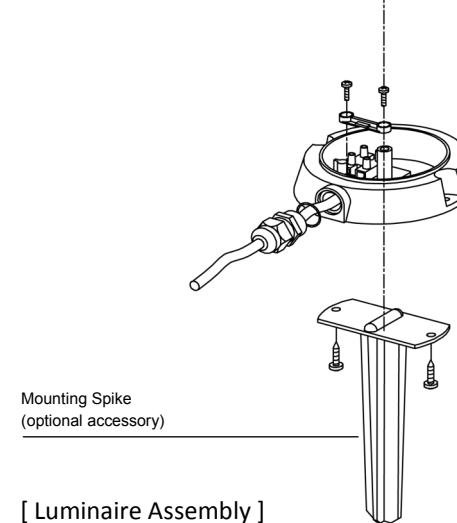

Mounting Spike
(optional accessory)

[Luminaire Assembly]

Fig. 5

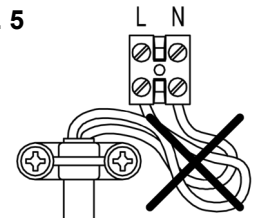
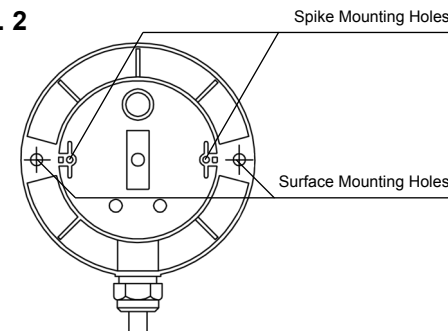

Fig. 2



Spike Mounting Holes

Surface Mounting Holes

[Surface Mounting]

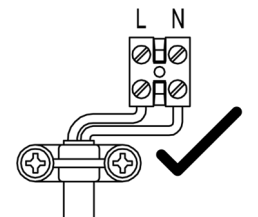

[Wire Routing]