

Whitecroft
lighting

Selene 2 Surface



Installation Instructions

Dec 2023 - Rev D

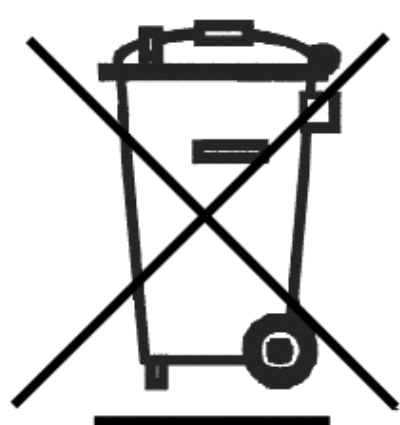
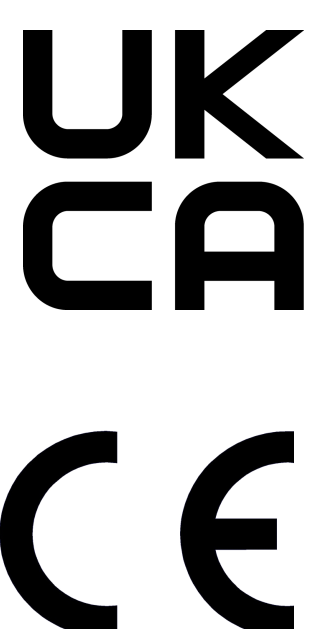

Whitecroft Lighting Limited

Burlington Street, Ashton-under-Lyne, Lancashire OL7 0AX

Telephone +44 (0)161 330 6811

Registered No. 3848973 England

Email: email@whitecroftlight.com

Registered Office: As above

Selene 2 Surface

High Voltage
LED's

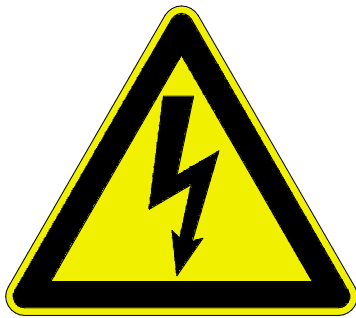

Electrostatic
Sensitive Device

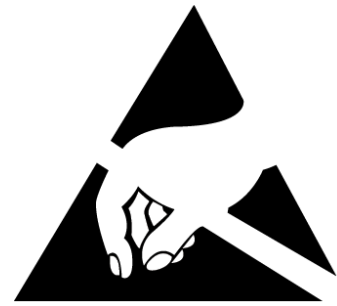

Whitecroft Lighting Limited

1. Remove the luminaire from packaging and inspect the contents for damage.
2. Ensure that the supporting ceiling structure is of adequate strength to support the weight of the luminaire and mark recommended fixing centres & cable entry position:

Variant	Model	Height (mm)	Width (mm)	Length (mm)	Mounting Centres (mm)	Weight (kg)	
						Standard	Emergency
Standalone Luminaire	1200	68	210	1322	1180	6.6	7.1
	1500			1607	1465	7.7	8.2
	1800			1887	1745	8.8	9.3

LUMINAIRE DIMENSIONS & SPECIFICATION

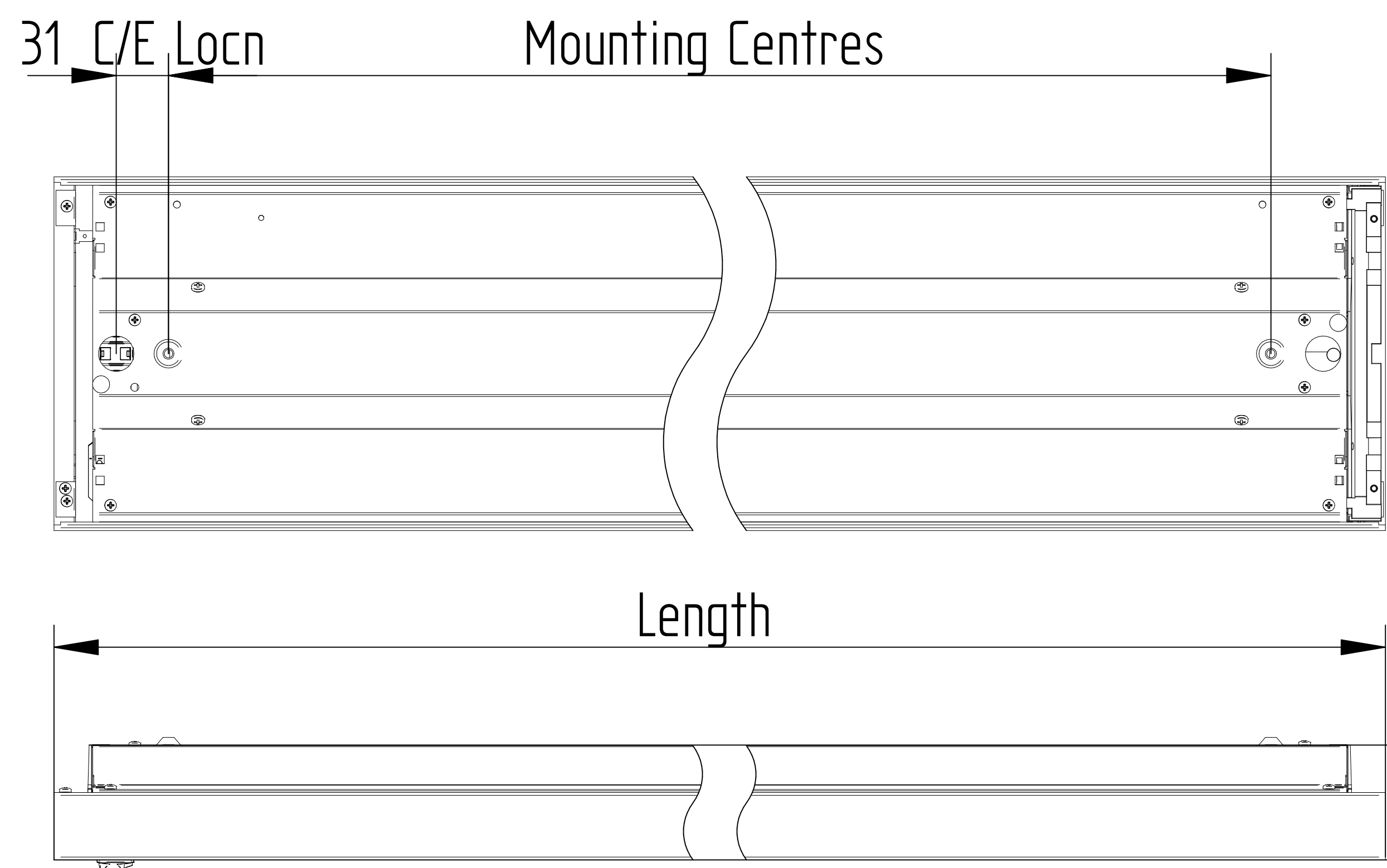

Specification - All variants	
Finish	RAL9003 White, RAL9016 Silver
Materials	Steel body, polycarbonate endcaps, acrylic diffusers.
Supply	220-240v AC50-60Hz
Connection	Cable section: 3-6 core-0.5mm ² to 2.5mm ² (6mm strip length)
Operating Temp	0°c to + 25°c
IP Rating	IP44 (IP40 OR3 Variants)

IP44 WATER DRAINAGE PATH

Drainage Path for any ingresss of water via diffuser & endcap joint as indicated right.

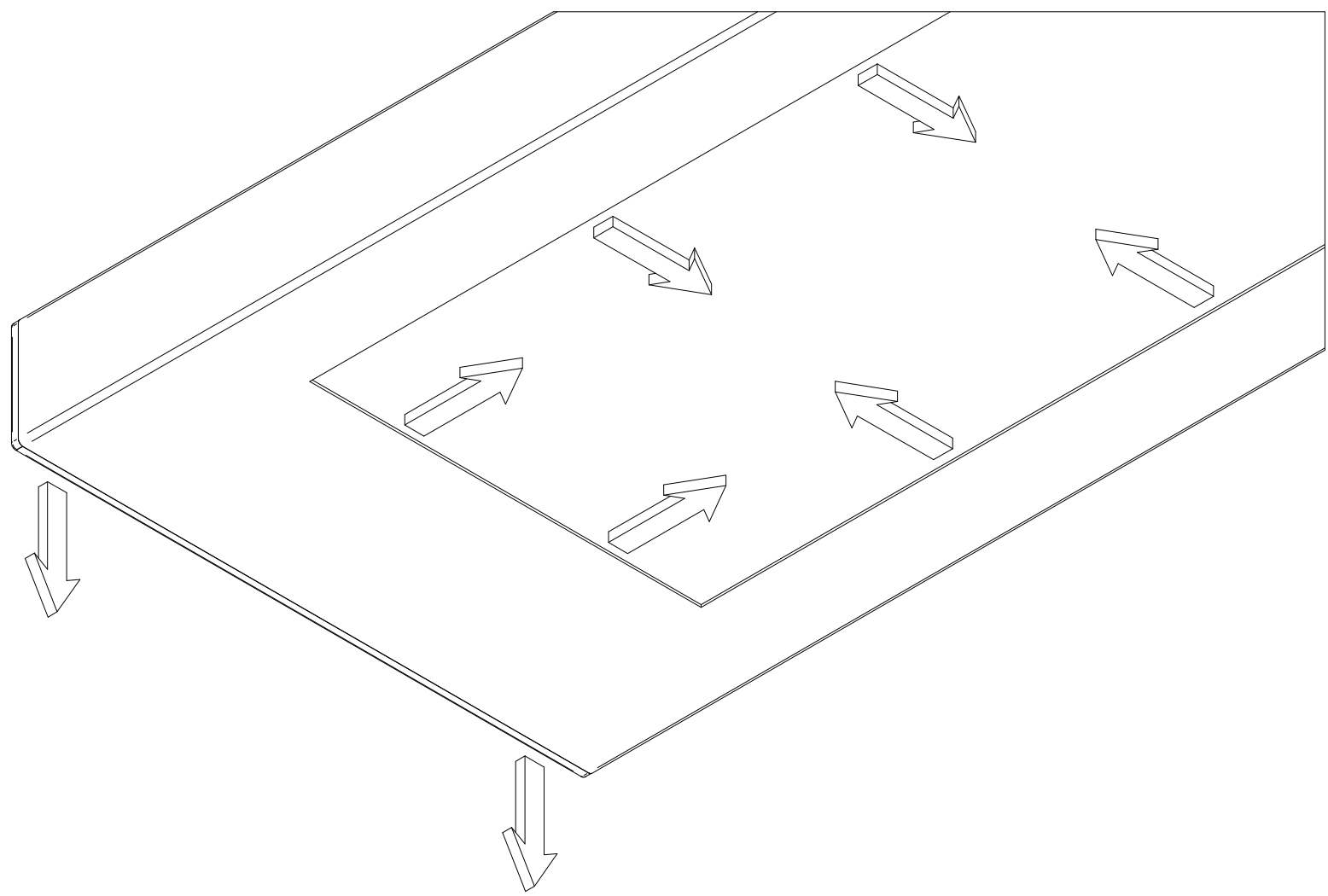

3. Remove the front diffuser optic assembly from the product by pushing up vertically & unhooking edges. Disconnect the safety & earth cords & sensor connection plug where fitted & set assy aside.

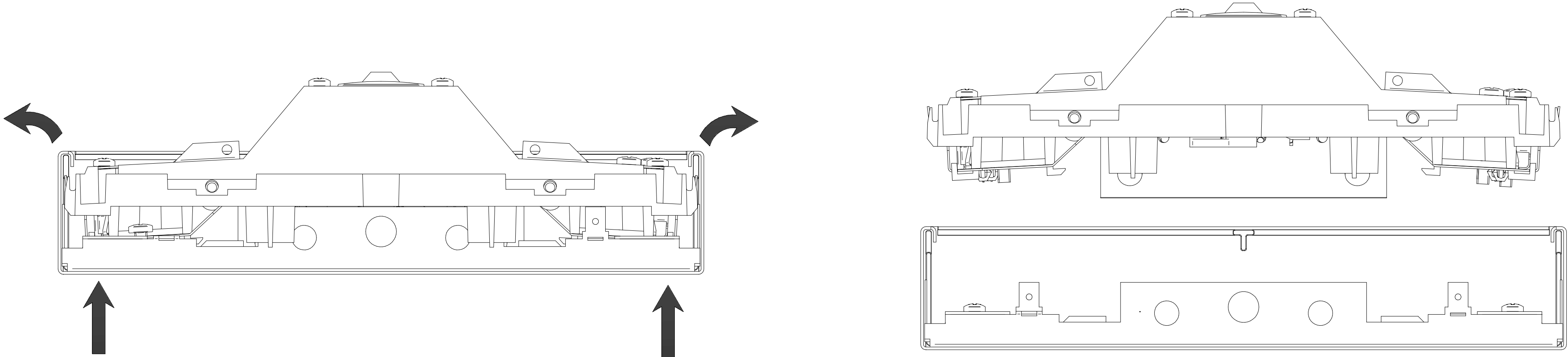

Selene 2 Surface

High Voltage
LED's

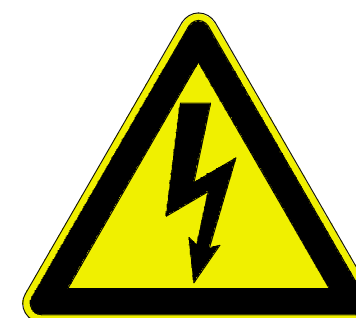

Electrostatic
Sensitive Device

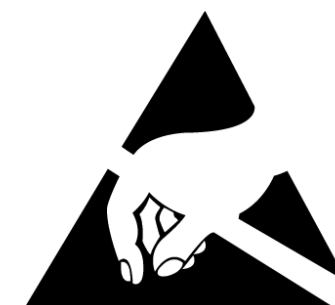

Whitecroft Lighting Limited

4a. Bend the indicated locking tabs on the geartray as shown.

4b. Remove geartray assembly by unhooking from plastic clips and allowing geartray to hinge & rotate to vertical position. Disconnect earth lead & remove geartray from back body. Set aside to prevent damage.

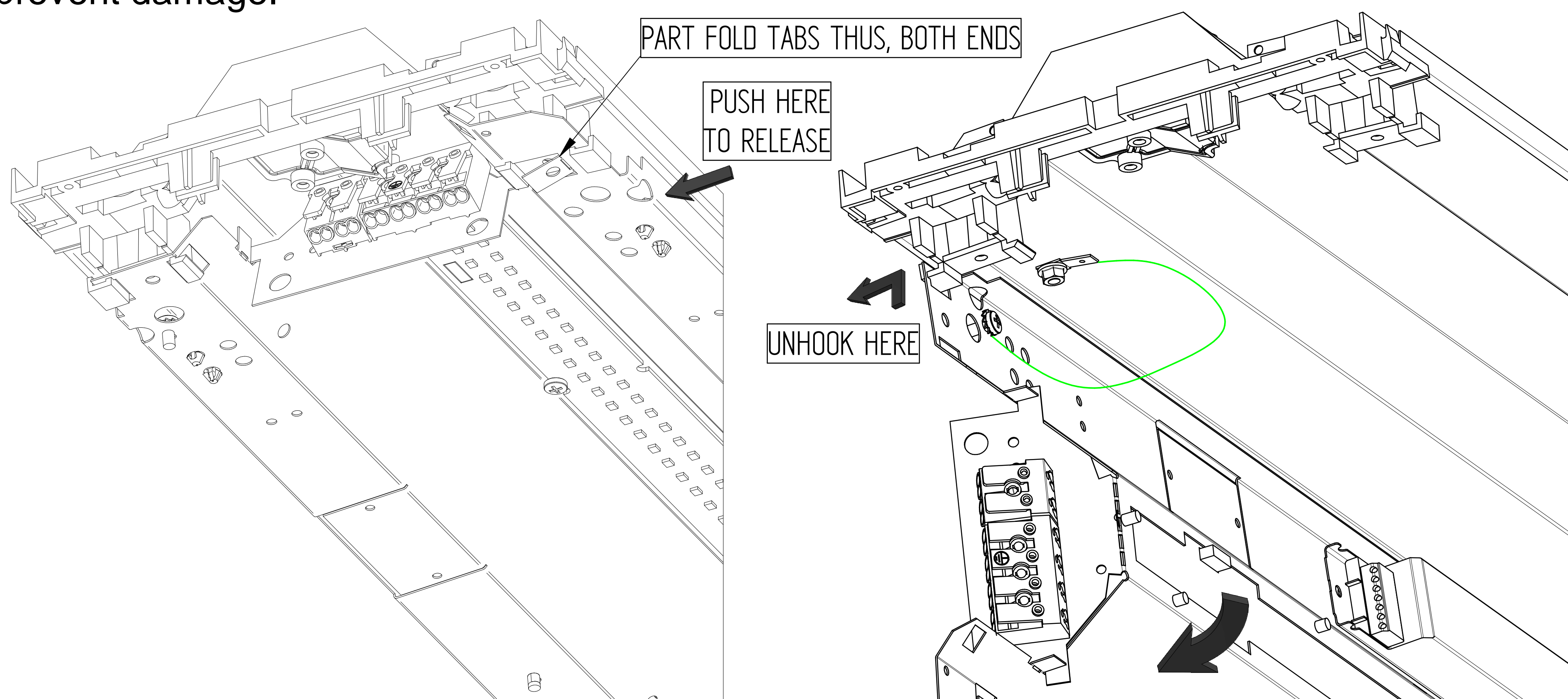

5a. Pierce the grommet and feed cable into luminaire before securing to endcap using clamp & screws provided. Ensure that there is 150mm of stripped cable available after the clamp.
(See note re separate emergency Dali cable entry)

5b Fit the supplied sleeving over stripped cables between cable clamp & terminal blocks

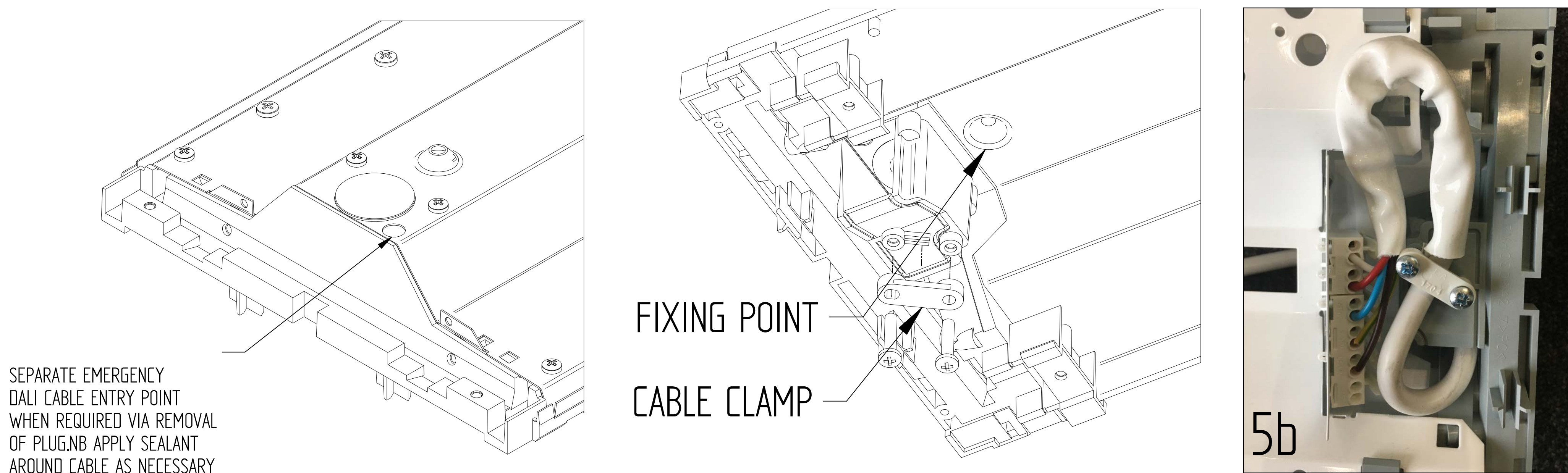

6. Screw the canopy to the ceiling using appropriate fixings (supplied by others) through the 5mm mounting holes at the centres indicated & prepare ceiling cable entry hole aperture

7. Re-hang geartray assembly onto the endcap plastic clips at both end & re-connect the earth lead.

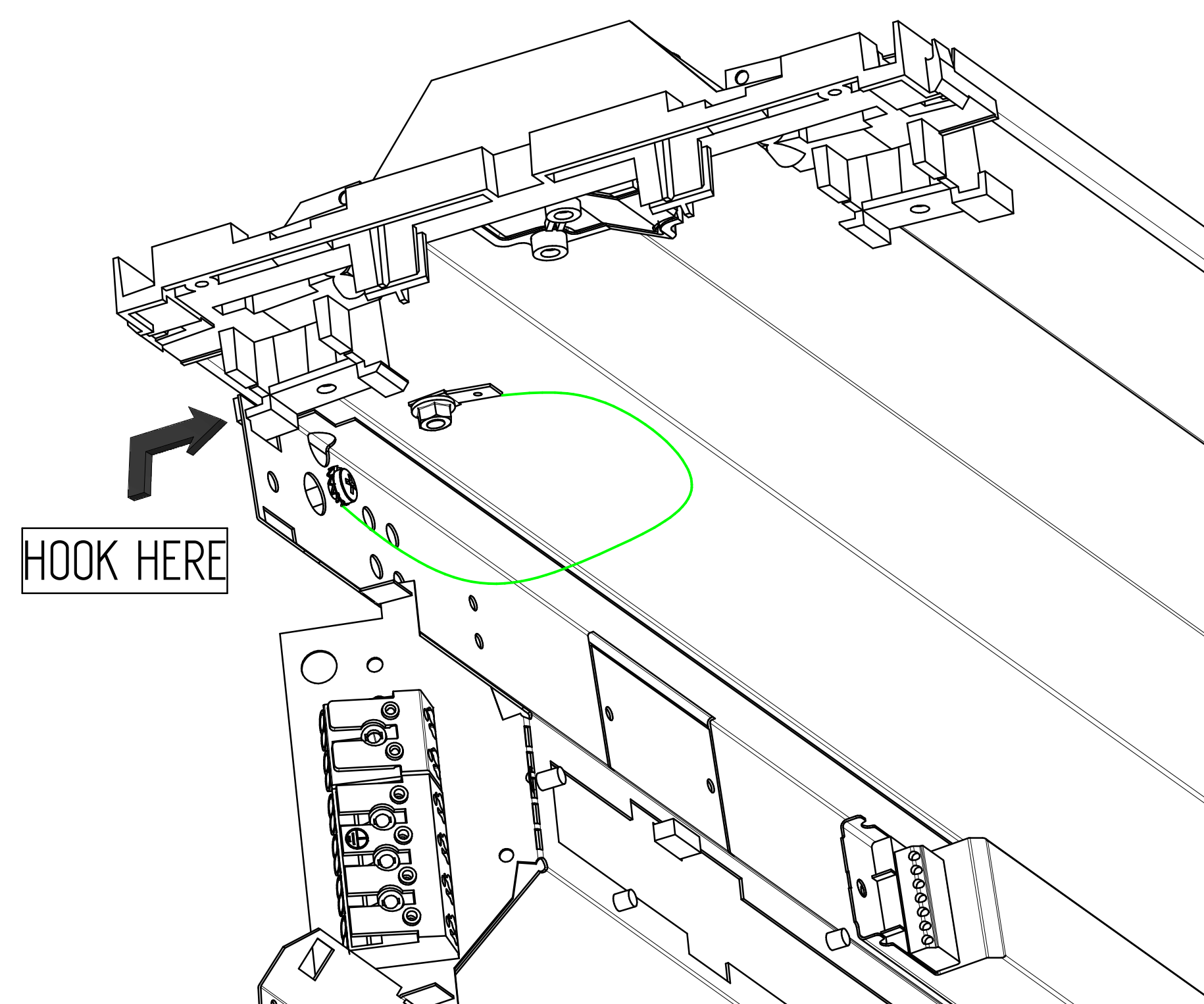

Selene 2 Surface

High Voltage
LED's

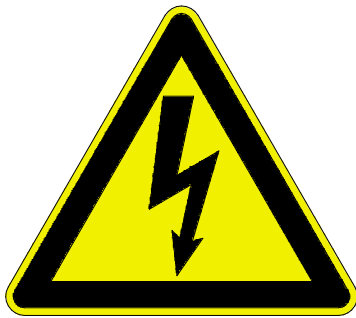

Electrostatic
Sensitive Device

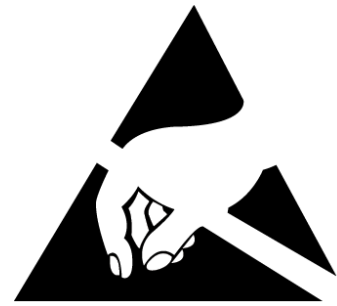

Whitecroft Lighting Limited

8. Wire mains / Dali cable into the Luminaire terminal blocks as per below (variant dependant)

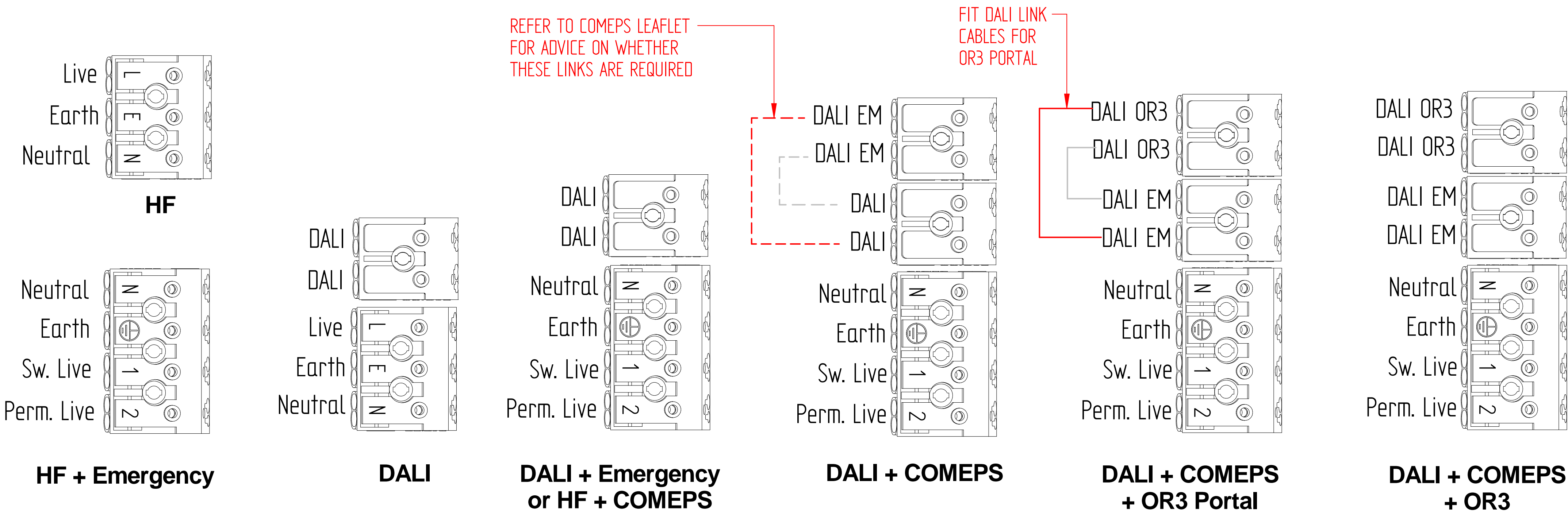

9. If emergency product connect battery plug & socket & note commissioning date.

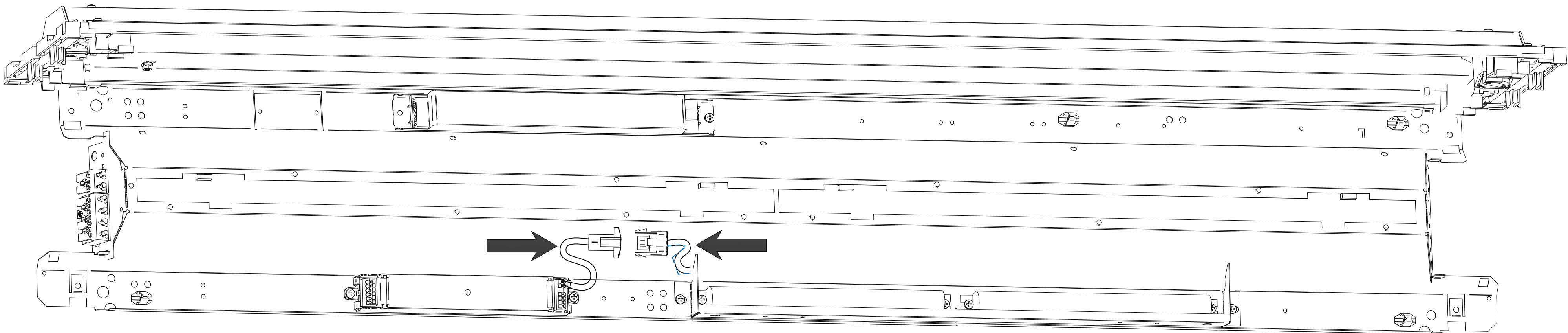

10. Refit the geartray assembly to the horizontal position ensuring that the plastic clips are fully engaged at both ends & the locking tabs are folded flat to their original position.

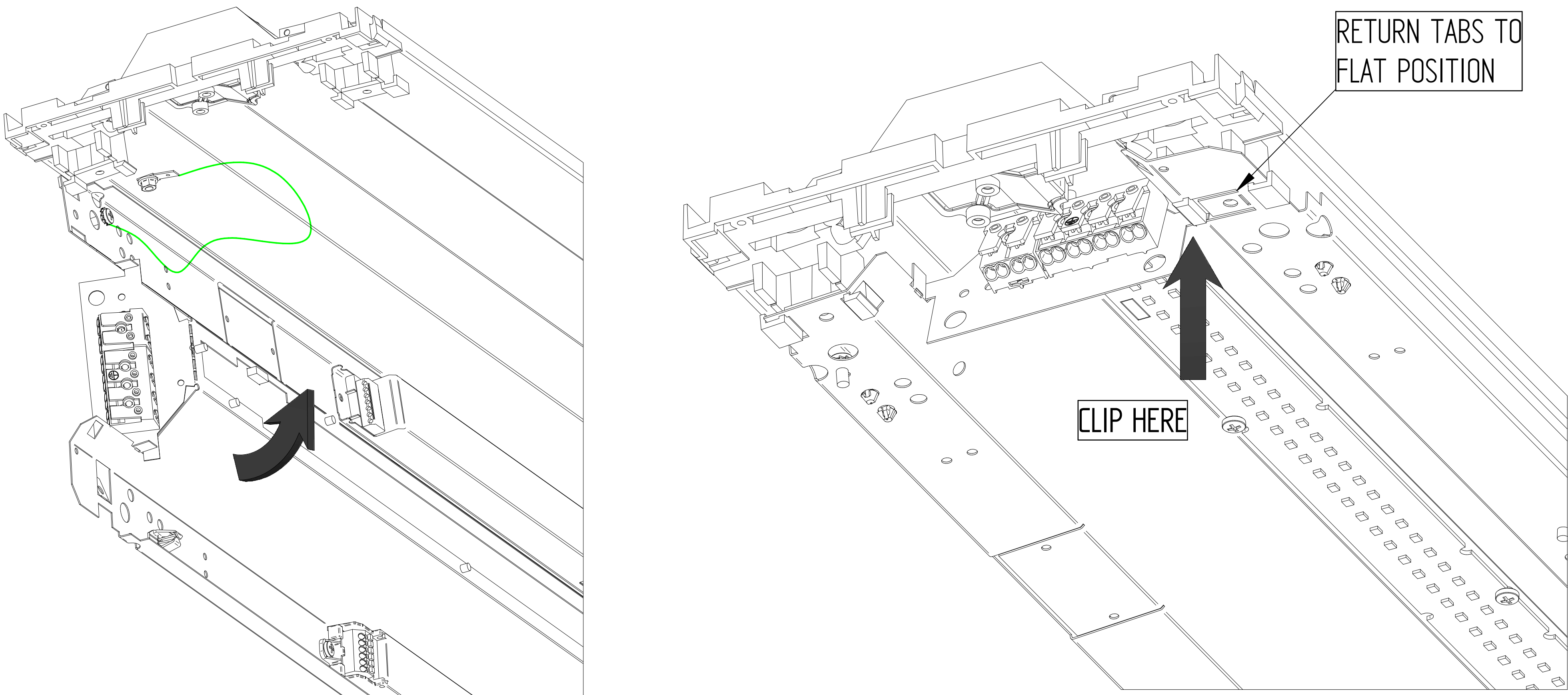

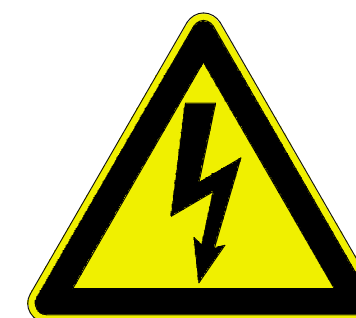

11. Re-attach earth & safety cords to the diffuser assembly & connect Sensor plug where fitted.

12. Align the front diffuser assembly with the canopy & re-attach to canopy by pushing up from the front until hook on both sides are fully clipped over the canopy edge along the entire length .

Nb Care should be taken to ensure that no cables are trapped during the fitting process.

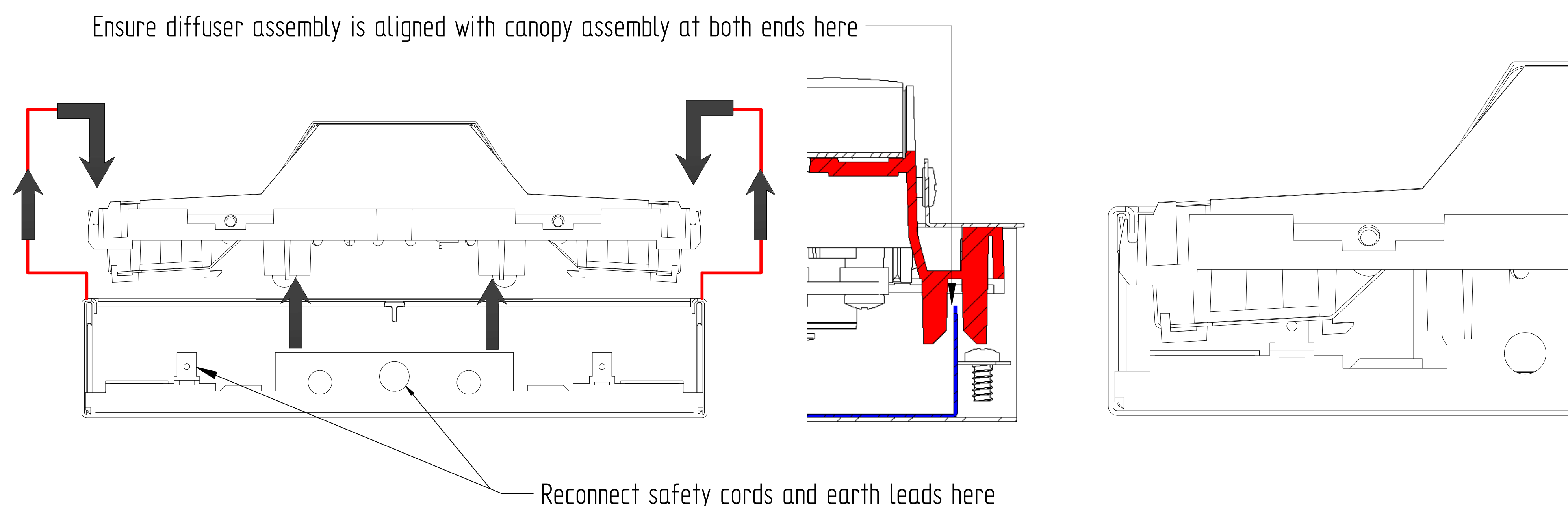

13. Fit locking plates at each end of luminaire with screws provided.

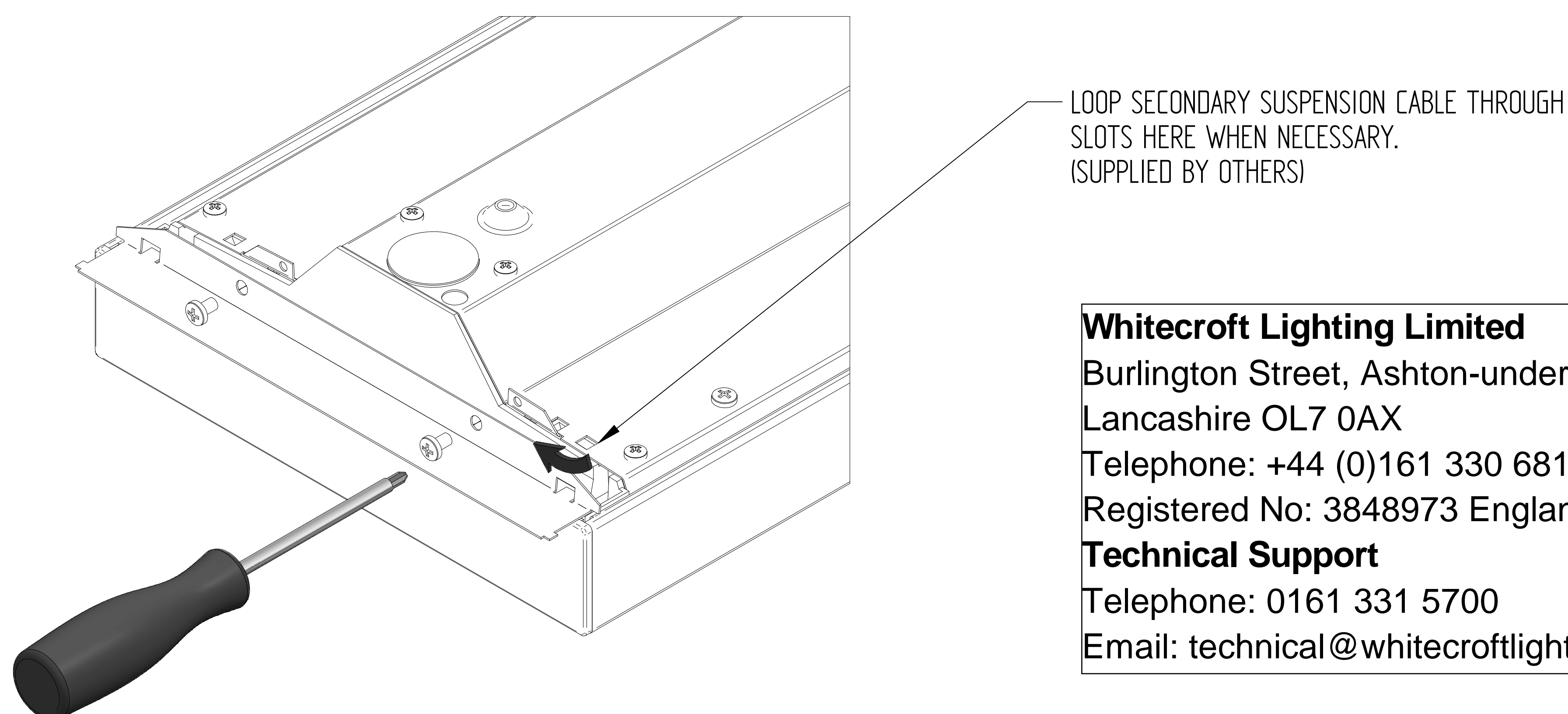

Whitecroft Lighting Limited
Burlington Street, Ashton-under-Lyne,
Lancashire OL7 0AX
Telephone: +44 (0)161 330 6811
Registered No: 3848973 England
Technical Support
Telephone: 0161 331 5700
Email: technical@whitecroftlight.com

GENERAL SAFETY INFORMATION.

1. A qualified electrician, in accordance with IEE wiring regulations should carry out connection to the mains wiring.
2. Ensure that the rated voltage and the frequency requirements are compatible with the available mains supply.
3. This luminaire must be earthed.
4. Observe ESD precautions during installation.
5. The Luminaire must be isolated before commencing any necessary maintenance work or emergency battery connection.
6. Do not carry out high voltage insulation test, i.e. 500/1000v this may damage internal components.
7. The light source within this luminaire shall only be replaced by the manufacturer, their agent or a suitably qualified person.
8. Batteries used in emergency versions of this luminaire range are replaceable by a qualified electrician only.
9. Dali control cables must be double insulated & have an equivalent insulation rating to the supply cable.
10. Ensure that the ceiling is of sufficient strength to support the luminaire weight. Fit secondary suspensions where necessary.
11. It is recommended that a minimum of two people undertake installation of luminaires.
12. Battery access for maintenance & replacement purposes is the reversal of steps 11,10,9,7 (Infills can remain in situ)